

M5 Junction 10 Improvements Scheme

Land Plans TR010063 - APP 2.2

Regulation 5(2)(i)(I)(II)(III)
Planning Act 2008

Infrastructure Planning (Applications: Prescribed Forms and Procedure) Regulations 2009

Volume 2
October 2024

THIS PAGE IS LEFT INTENTIONALLY BLANK

Infrastructure Planning Planning Act 2008

The Infrastructure Planning (Applications: Prescribed Forms and Procedure) Regulations 2009

M5 Junction 10 Improvements Scheme Development Consent Order 202[x]

2.2 Land Plans

Regulation Number:	Regulation 5(2)(i)(I)(II)(III)
Planning Inspectorate Scheme Reference	TR010063
Application Document Reference	TR010063 – APP 2.2
Author:	M5 Junction 10 Improvements Scheme Project Team

Version	Date	Status of Version
Rev 0	December 2023	DCO Application
Rev 1	March 2024	Section 51
Rev 2	June 2024	Deadline 1
Rev 3	July 2024	Deadline 3
Rev 4	September 2024	Deadline 4
Rev 5	October 2024	Deadline 5

1. Schedule of plans included in this application document

Document title	Document number	Version
2.2 Land Plans – Key Regulation 5(2)(i)	TR010063 – APP 2.2	C03
2.2 Land Plans – Sheet 1 of 16 Regulation 5(2)(i)	TR010063 – APP 2.2	C02
2.2 Land Plans – Sheet 2 of 16 Regulation 5(2)(i)6	TR010063 – APP 2.2	C03
2.2 Land Plans – Sheet 3 of 16 Regulation 5(2)(i)	TR010063 – APP 2.2	C05
2.2 Land Plans – Sheet 4 of 16 Regulation 5(2)(i)	TR010063 – APP 2.2	C03
2.2 Land Plans – Sheet 5 of 16 Regulation 5(2)(i)	TR010063 – APP 2.2	C0 43
<u>2.2 Land Plans – Sheet 5A of 16 Regulation 5(2)(i)</u>	<u>TR010063 – APP 2.2</u>	<u>C01</u>
2.2 Land Plans – Sheet 6 of 16 Regulation 5(2)(i)	TR010063 – APP 2.2	C0 43
2.2 Land Plans – Sheet 7 of 16 Regulation 5(2)(i)	TR010063 – APP 2.2	C0 43
2.2 Land Plans – Sheet 8 of 16 Regulation 5(2)(i)	TR010063 – APP 2.2	C02
2.2 Land Plans – Sheet 9 of 16 Regulation 5(2)(i)	TR010063 – APP 2.2	C02
2.2 Land Plans – Sheet 10 of 16 Regulation 5(2)(i)	TR010063 – APP 2.2	C02
2.2 Land Plans – Sheet 11 of 16 Regulation 5(2)(i)	TR010063 – APP 2.2	C02
2.2 Land Plans – Sheet 12 of 16 Regulation 5(2)(i)	TR010063 – APP 2.2	C0 43
2.2 Land Plans – Sheet 12A of 16 Regulation 5(2)(i)	TR010063 – APP 2.2	C0 32
2.2 Land Plans – Sheet 13 of 16 Regulation 5(2)(i)	TR010063 – APP 2.2	C0 43
2.2 Land Plans – Sheet 13A of 16 Regulation 5(2)(i)	TR010063 – APP 2.2	C0 32
2.2 Land Plans – Sheet 14 of 16 Regulation 5(2)(1)	TR010663 – APP 2.2	C0 43

Document title	Document number	Version
2.2 Land Plans – Sheet 15 of 16 Regulation 5(2)(i)	TR010063 – APP 2.2	C02
2.2 Land Plans – Sheet 16 of 16 Regulation 5(2)(i)	TR010063 – APP 2.2	C0 5 4
2.2 Land Plans – Sheet 16A of 16 Regulation 5(2)(i)	TR010063 – APP 2.2	C0 4 3

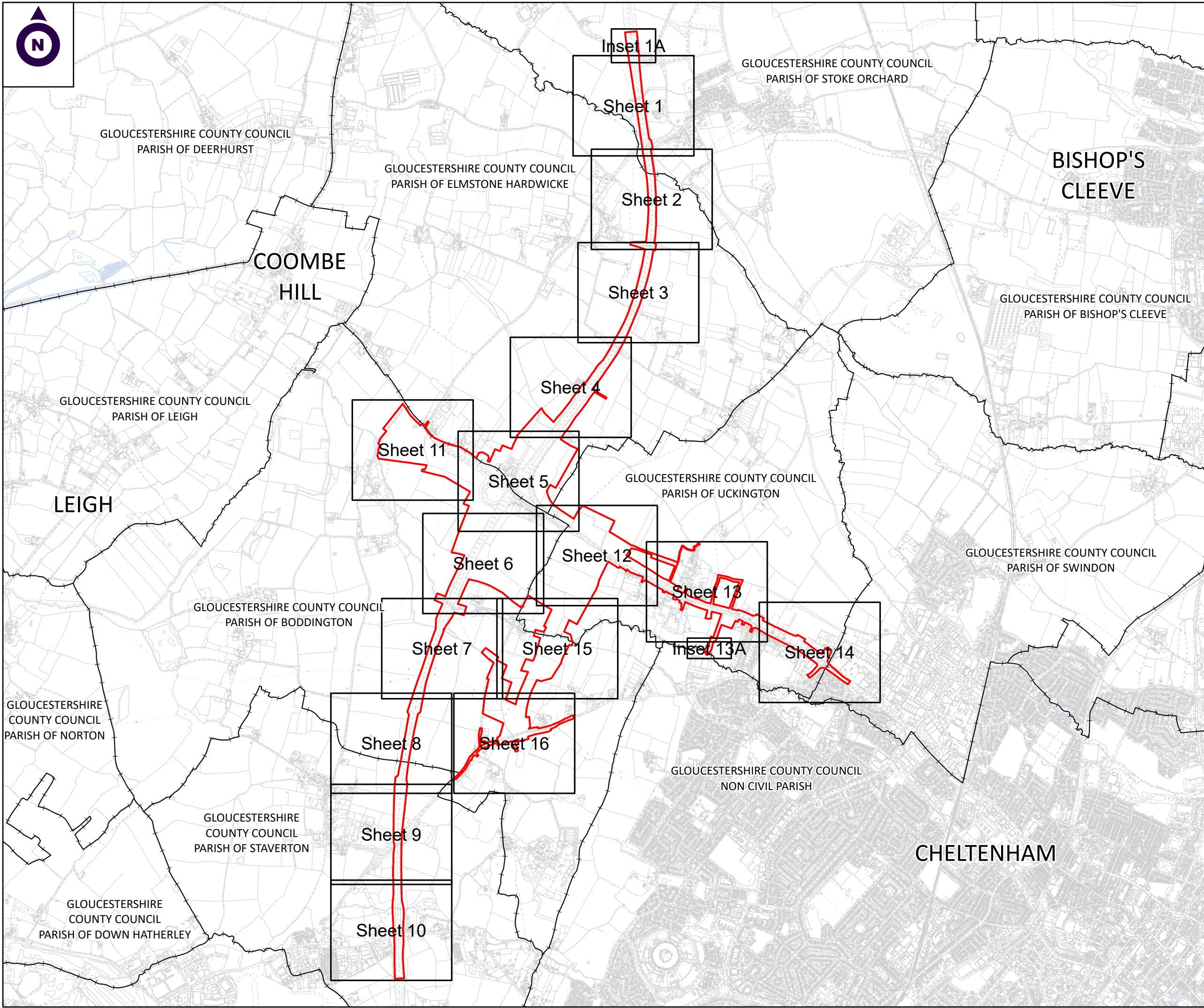

NOTES:

1. ALL DIMENSIONS ARE IN METRES UNLESS STATED OTHERWISE.
2. ALL EASEMENTS, SERVITUDES AND PRIVATE RIGHTS ARE PROPOSED TO BE EXTINGUISHED ON LAND, COLOURED PINK ON THESE LAND PLANS UNLESS STATED OTHERWISE IN THE BOOK OF REFERENCE. ALL EASEMENTS, SERVITUDES AND PRIVATE RIGHTS ARE PROPOSED TO BE EXTINGUISHED, SO FAR AS THEIR CONTINUED EXERCISE WOULD BE INCONSISTENT WITH THE EXERCISE OF THE RIGHTS AND RESTRICTIONS PROPOSED TO BE ACQUIRED BY THE UNDERTAKER ON LAND COLOURED BLUE ON THESE LAND PLANS UNLESS STATED OTHERWISE IN THE BOOK OF REFERENCE. ALL EASEMENTS, SERVITUDES AND PRIVATE RIGHTS ARE PROPOSED TO BE SUSPENDED WHILE THE UNDERTAKER IS IN TEMPORARY POSSESSION OF THE LAND COLOURED GREEN ON THESE LAND PLANS UNLESS STATED OTHERWISE IN THE BOOK OF REFERENCE.
3. THIS DRAWING IS TO BE READ IN CONJUNCTION WITH ALL OTHER PLANS AND DOCUMENTATION, IN PARTICULAR THE WORKS PLANS AND THE BOOK OF REFERENCE.

LEGEND

- ORDER LIMITS
- PARISH BOUNDARY

Second Revision	By SC	29/02/2024	C02
Third Revision	By SC	24/07/2024	C03
Revision Details	By Check	Date	Suffix

Purpose of Issue: **DCO APPLICATION**

Client: Gloucestershire County Council

Development Consent Order Number:
TR010063

Project Title:
M5 JUNCTION 10 IMPROVEMENTS SCHEME

Development Consent Order Drawing Number:
TR010063/APP/2.2

Drawing Title:
LAND PLANS REGULATION 5(2)(i) KEY SHEET

Designed:	Drawn:	Checked:	Date:
--	SC	LE	24/07/2024

Internal Project Number:	Suitability:
J0041885-24-00h	DCO Submission

Scale @ A3:	Zone:
1:25,000	Whole Site

THIS DOCUMENT HAS BEEN PREPARED PURSUANT TO AND SUBJECT TO THE TERMS OF CARTER JONAS' APPOINTMENT BY ITS CLIENT. CARTER JONAS ACCEPTS NO LIABILITY FOR ANY USE OF THIS DOCUMENT OTHER THAN BY ITS ORIGINAL CLIENT OR FOLLOWING CARTER JONAS' EXPRESS AGREEMENT TO SUCH USE, AND ONLY FOR THE PURPOSES FOR WHICH IT WAS PREPARED AND PROVIDED

Rev:	C03
------	-----

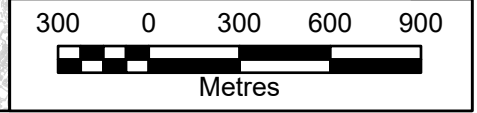

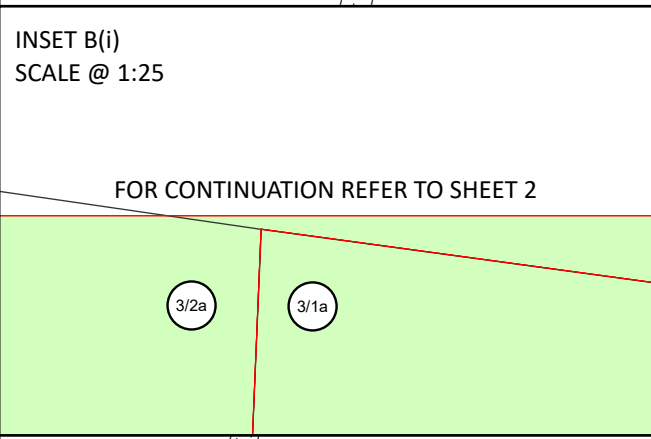
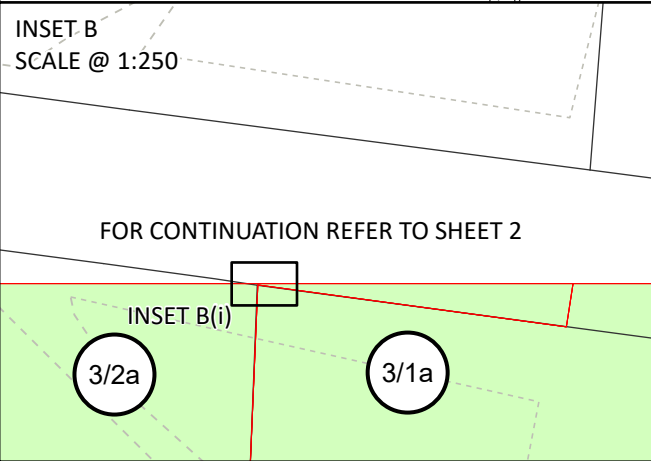
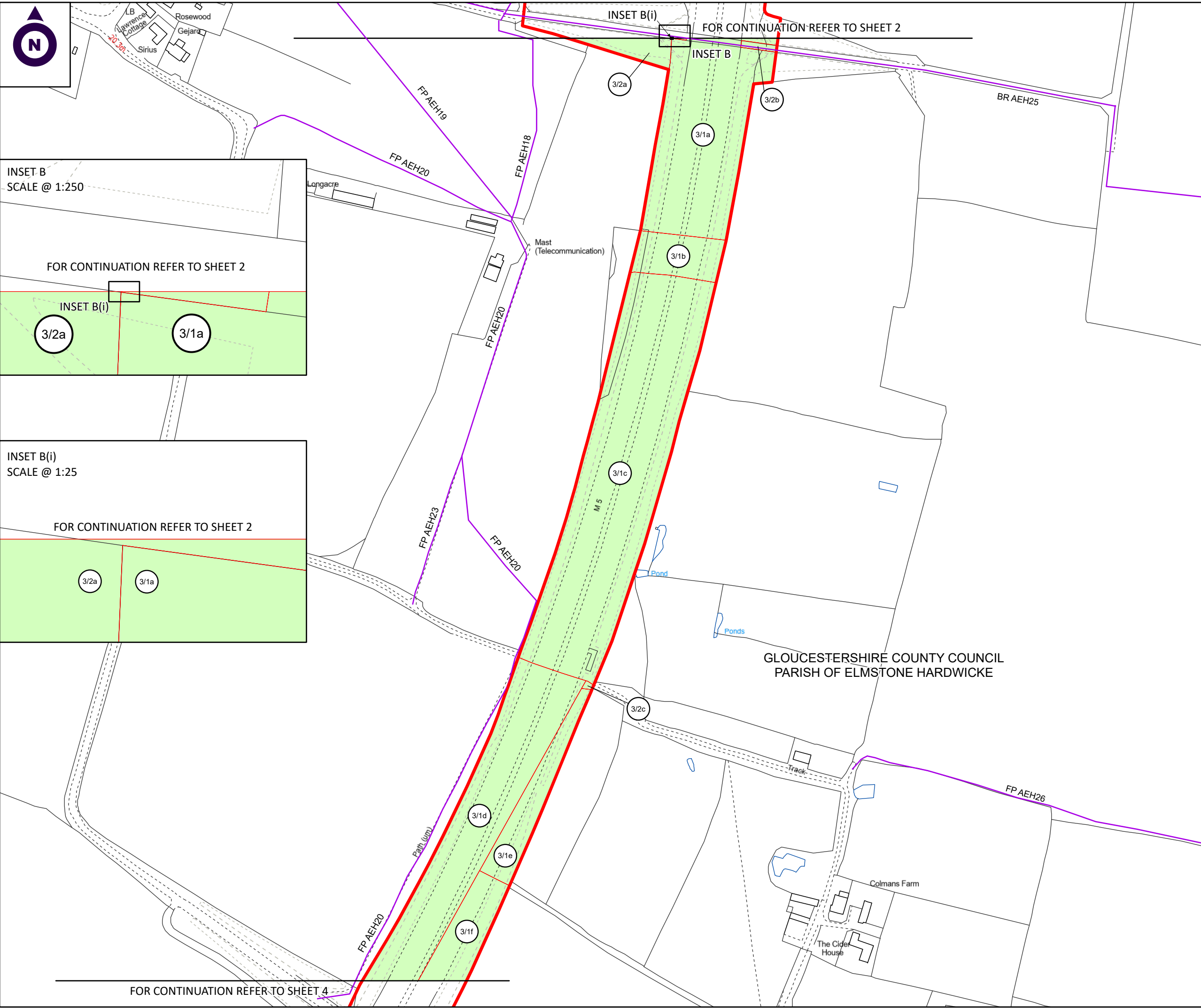

NOTES:

1. ALL DIMENSIONS ARE IN METRES UNLESS STATED OTHERWISE.
2. ALL EASEMENTS, SERVITUDES AND PRIVATE RIGHTS ARE PROPOSED TO BE EXTINGUISHED ON LAND COLOURED PINK ON THESE LAND PLANS UNLESS STATED OTHERWISE IN THE BOOK OF REFERENCE. ALL EASEMENTS, SERVITUDES AND PRIVATE RIGHTS ARE PROPOSED TO BE EXTINGUISHED, SO FAR AS THEIR CONTINUED EXERCISE WOULD BE INCONSISTENT WITH THE EXERCISE OF THE RIGHTS AND RESTRICTIONS PROPOSED TO BE ACQUIRED BY THE UNDERTAKER ON LAND COLOURED BLUE ON THESE LAND PLANS UNLESS STATED OTHERWISE IN THE BOOK OF REFERENCE. ALL EASEMENTS, SERVITUDES AND PRIVATE RIGHTS ARE PROPOSED TO BE SUSPENDED WHILE THE UNDERTAKER IS IN TEMPORARY POSSESSION OF THE LAND COLOURED GREEN ON THESE LAND PLANS UNLESS STATED OTHERWISE IN THE BOOK OF REFERENCE.
3. THIS DRAWING IS TO BE READ IN CONJUNCTION WITH ALL OTHER PLANS AND DOCUMENTATION, IN PARTICULAR THE WORKS PLANS AND THE BOOK OF REFERENCE.

LEGEND

- ORDER LIMITS
- PARISH BOUNDARY
- PLOT REFERENCE NUMBER
- LAND TO BE ACQUIRED PERMANENTLY
- LAND TO BE USED TEMPORARILY
- LAND TO BE USED TEMPORARILY AND RIGHTS TO BE ACQUIRED PERMANENTLY

Revision	By	Date	Suffix
Third Revision	By SC	11/06/2024	C03
Fourth Revision	By SC	24/07/2024	C04
Fifth Revision	By SC	29/08/2024	C05
Revision Details	By	Date	Suffix
	Check		

Purpose of Issue: **DCO APPLICATION**

Client: Gloucestershire County Council

Development Consent Order Number: **TR010063**

Project Title: **M5 JUNCTION 10 IMPROVEMENTS SCHEME**

Development Consent Order Drawing Number: **TR010063/APP/2.2**

Drawing Title: **LAND PLANS REGULATION 5(2)(i) SHEET 3 OF 16**

Designed: --	Drawn: SC	Checked: JC	Date: 29/08/2024
--------------	-----------	-------------	------------------

Internal Project Number: J0041885-24-03(i)	Suitability: DCO Submission
--	-----------------------------

Scale @ A3: 1:2,500	Zone: Whole Site
---------------------	------------------

THIS DOCUMENT HAS BEEN PREPARED PURSUANT TO AND SUBJECT TO THE TERMS OF CARTER JONAS' APPOINTMENT BY ITS CLIENT. CARTER JONAS ACCEPTS NO LIABILITY FOR ANY USE OF THIS DOCUMENT OTHER THAN BY ITS ORIGINAL CLIENT OR FOLLOWING CARTER JONAS' EXPRESS AGREEMENT TO SUCH USE, AND ONLY FOR THE PURPOSES FOR WHICH IT WAS PREPARED AND PROVIDED

Rev: C05

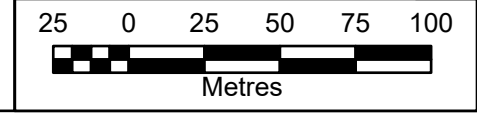



GLOUCESTERSHIRE COUNTY COUNCIL
PARISH OF ELMSTONE HARDWICKE

FOR CONTINUATION REFER TO SHEET 3

FR A/EH20

STANBORO LANE

Barn Farm

M5

M5

FOR CONTINUATION REFER TO SHEET 5

Sheldon Nurseries

NOTES:

1. ALL DIMENSIONS ARE IN METRES UNLESS STATED OTHERWISE.
2. ALL EASEMENTS, SERVITUDES AND PRIVATE RIGHTS ARE PROPOSED TO BE EXTINGUISHED ON LAND COLOURED PINK ON THESE LAND PLANS UNLESS STATED OTHERWISE IN THE BOOK OF REFERENCE. ALL EASEMENTS, SERVITUDES AND PRIVATE RIGHTS ARE PROPOSED TO BE EXTINGUISHED, SO FAR AS THEIR CONTINUED EXERCISE WOULD BE INCONSISTENT WITH THE EXERCISE OF THE RIGHTS AND RESTRICTIONS PROPOSED TO BE ACQUIRED BY THE UNDERTAKER ON LAND COLOURED BLUE ON THESE LAND PLANS UNLESS STATED OTHERWISE IN THE BOOK OF REFERENCE. ALL EASEMENTS, SERVITUDES AND PRIVATE RIGHTS ARE PROPOSED TO BE SUSPENDED WHILE THE UNDERTAKER IS IN TEMPORARY POSSESSION OF THE LAND COLOURED GREEN ON THESE LAND PLANS UNLESS STATED OTHERWISE IN THE BOOK OF REFERENCE.
3. THIS DRAWING IS TO BE READ IN CONJUNCTION WITH ALL OTHER PLANS AND DOCUMENTATION, IN PARTICULAR THE WORKS PLANS AND THE BOOK OF REFERENCE.

LEGEND

- ORDER LIMITS
- EXISTING PUBLIC RIGHT OF WAY
- PARISH BOUNDARY
- PLOT REFERENCE NUMBER
- LAND TO BE ACQUIRED PERMANENTLY
- LAND TO BE USED TEMPORARILY
- LAND TO BE USED TEMPORARILY AND RIGHTS TO BE ACQUIRED PERMANENTLY

Revision	By	Check	Date	Suffix
First Revision	SC		29/02/2024	C01
Second Revision	SC		24/07/2024	C02
Third Revision	SC		29/08/2024	C03

Purpose of Issue: DCO APPLICATION

Client: Gloucestershire County Council

Development Consent Order Number: TR010063

Project Title: M5 JUNCTION 10 IMPROVEMENTS SCHEME

Development Consent Order Drawing Number: TR010063/APP/2.2

Drawing Title: LAND PLANS REGULATION 5(2)(i) SHEET 4 OF 16

Designed: --	Drawn: SC	Checked: JC	Date: 29/08/2024
--------------	-----------	-------------	------------------

Internal Project Number: J0041885-24-04(i)	Suitability: DCO Submission
--	-----------------------------

Scale @ A3: 1:2,500	Zone: Whole Site
---------------------	------------------

THIS DOCUMENT HAS BEEN PREPARED PURSUANT TO AND SUBJECT TO THE TERMS OF CARTER JONAS' APPOINTMENT BY ITS CLIENT. CARTER JONAS ACCEPTS NO LIABILITY FOR ANY USE OF THIS DOCUMENT OTHER THAN BY ITS ORIGINAL CLIENT OR FOLLOWING CARTER JONAS' EXPRESS AGREEMENT TO SUCH USE, AND ONLY FOR THE PURPOSES FOR WHICH IT WAS PREPARED AND PROVIDED

Rev: C03

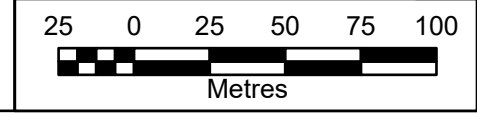



GLOUCESTERSHIRE
COUNTY COUNCIL
PARISH OF ELMSTONE
HARDWICKE

FOR CONTINUATION REFER TO SHEET 4

NOTES:
1. ALL DIMENSIONS ARE IN METRES UNLESS STATED OTHERWISE.
2. ALL EASEMENTS, SERVITUDES AND PRIVATE RIGHTS ARE PROPOSED TO BE EXTINGUISHED ON LAND COLOURED PINK ON THESE LAND PLANS UNLESS STATED OTHERWISE IN THE BOOK OF REFERENCE. ALL EASEMENTS, SERVITUDES AND PRIVATE RIGHTS ARE PROPOSED TO BE EXTINGUISHED, SO FAR AS THEIR CONTINUED EXERCISE WOULD BE INCONSISTENT WITH THE EXERCISE OF THE RIGHTS AND RESTRICTIONS PROPOSED TO BE ACQUIRED BY THE UNDERTAKER ON LAND COLOURED BLUE ON THESE LAND PLANS UNLESS STATED OTHERWISE IN THE BOOK OF REFERENCE. ALL EASEMENTS, SERVITUDES AND PRIVATE RIGHTS ARE PROPOSED TO BE SUSPENDED WHILE THE UNDERTAKER IS IN TEMPORARY POSSESSION OF THE LAND COLOURED GREEN ON THESE LAND PLANS UNLESS STATED OTHERWISE IN THE BOOK OF REFERENCE.
3. THIS DRAWING IS TO BE READ IN CONJUNCTION WITH ALL OTHER PLANS AND DOCUMENTATION, IN PARTICULAR THE WORKS PLANS AND THE BOOK OF REFERENCE.

LEGEND
 ORDER LIMITS
 EXISTING PUBLIC RIGHT OF WAY
 PARISH BOUNDARY
 PLOT REFERENCE NUMBER
 LAND TO BE ACQUIRED PERMANENTLY
 LAND TO BE USED TEMPORARILY
 LAND TO BE USED TEMPORARILY AND RIGHTS TO BE ACQUIRED PERMANENTLY

Revision	By	Date	Suffix
Second Revision	SC	24/07/2024	C02
Third Revision	SC	29/08/2024	C03
Fourth Revision	SC	16/09/2024	C04
Revision Details	By	Date	Suffix
	Check		

Purpose of Issue:
DCO APPLICATION

Client: Gloucestershire County Council

Development Consent Order Number:
TR010063

Project Title:
**M5 JUNCTION 10
IMPROVEMENTS SCHEME**

Development Consent Order Drawing Number:
TR010063/APP/2.2

Drawing Title:
**LAND PLANS
REGULATION 5(2)(i)
SHEET 5 OF 16**

Designed:	Drawn:	Checked:	Date:
--	SC	LE	16/09/2024

Internal Project Number:	Suitability:
J0041885-24-051	DCO Submission

Scale @ A3:	Zone:
1:2,500	Whole Site

THIS DOCUMENT HAS BEEN PREPARED PURSUANT TO AND SUBJECT TO THE TERMS OF CARTER JONAS' APPOINTMENT BY ITS CLIENT. CARTER JONAS ACCEPTS NO LIABILITY FOR ANY USE OF THIS DOCUMENT OTHER THAN BY ITS ORIGINAL CLIENT OR FOLLOWING CARTER JONAS' EXPRESS AGREEMENT TO SUCH USE, AND ONLY FOR THE PURPOSES FOR WHICH IT WAS PREPARED AND PROVIDED

Rev:
C04

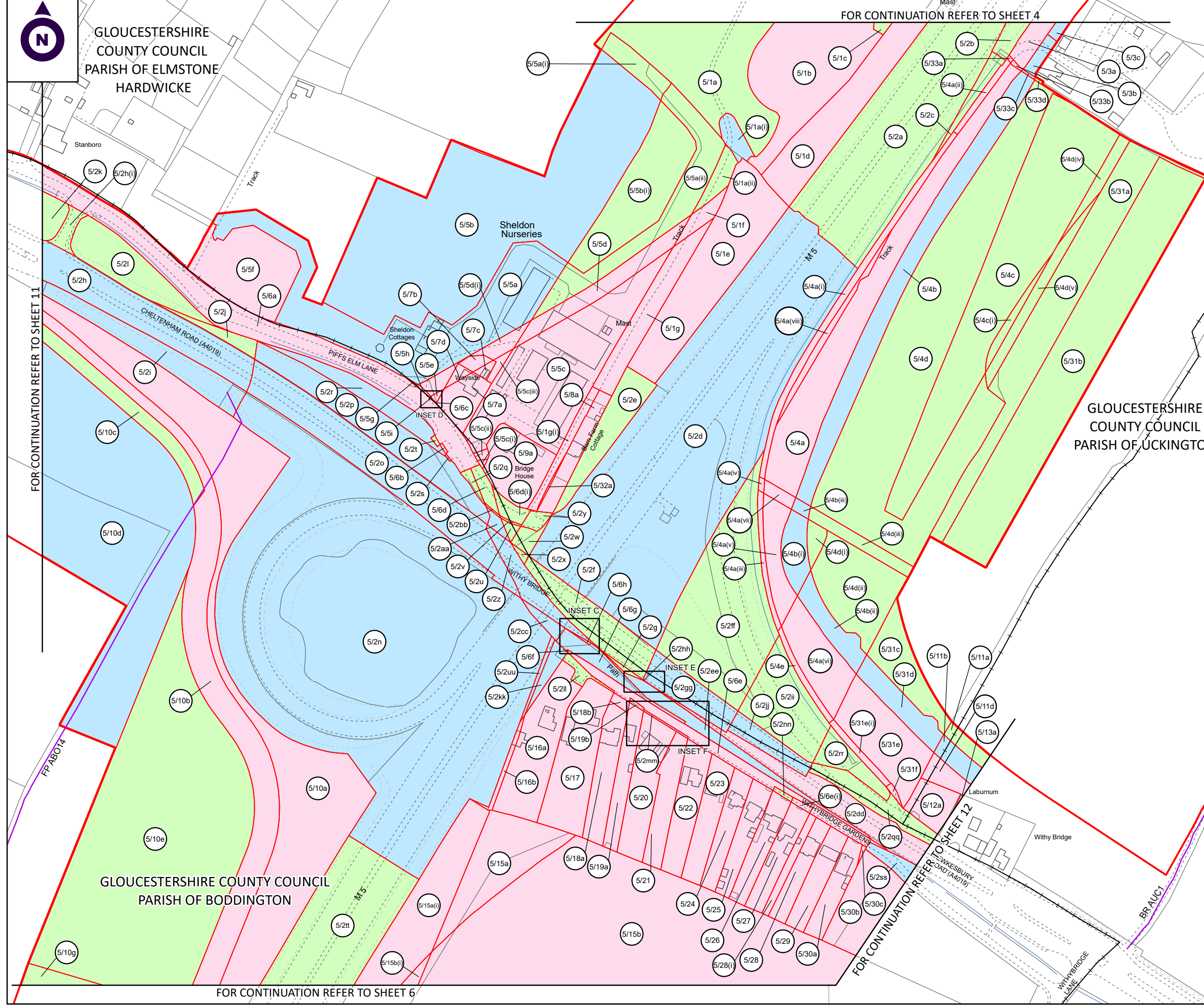
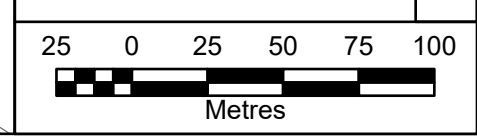



INSET C @1:500

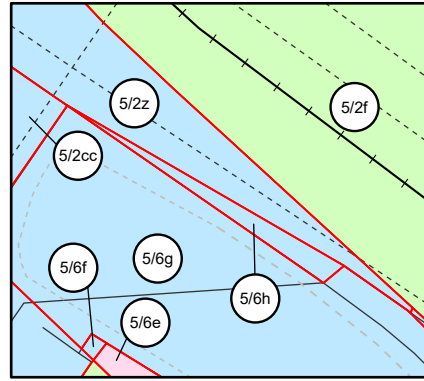

INSET D @1:250

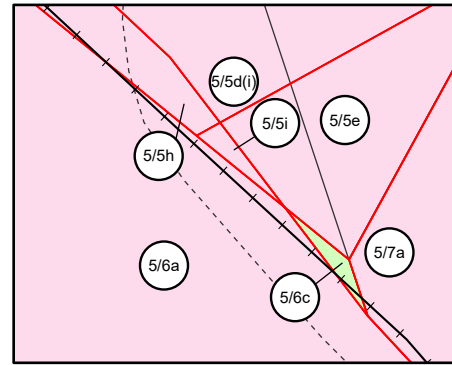

INSET E @1:250

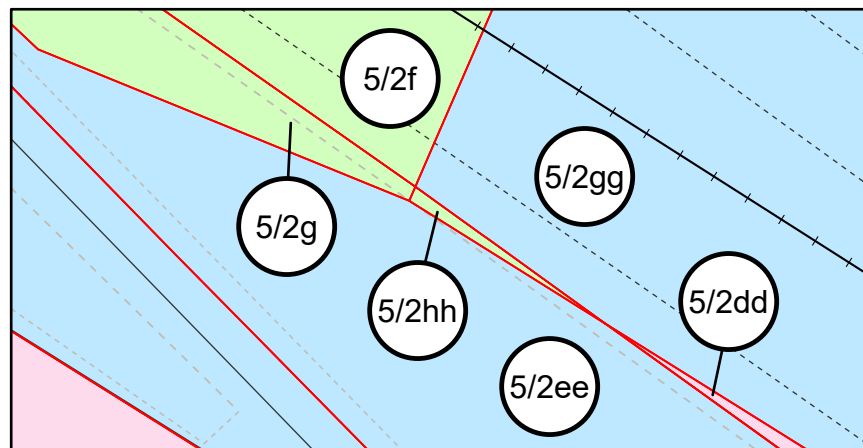

INSET F @1:500

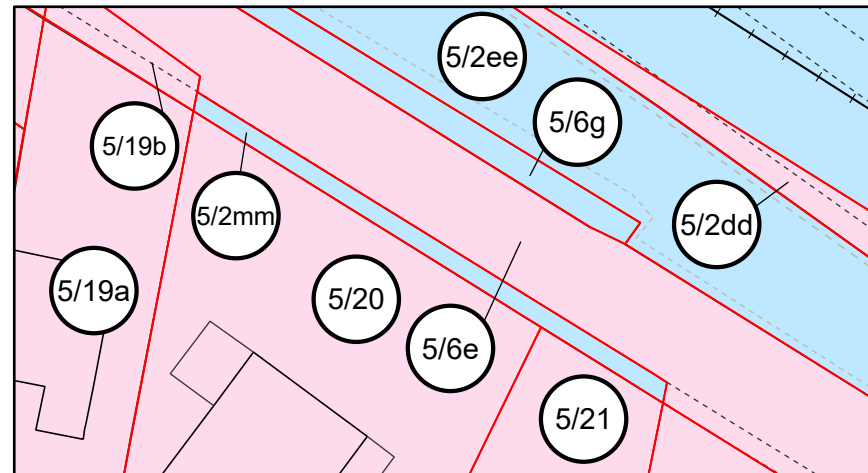

NOTES:

1. ALL DIMENSIONS ARE IN METRES UNLESS STATED OTHERWISE.
2. ALL EASEMENTS, SERVITUDES AND PRIVATE RIGHTS ARE PROPOSED TO BE EXTINGUISHED ON LAND COLOURED PINK ON THESE LAND PLANS UNLESS STATED OTHERWISE IN THE BOOK OF REFERENCE. ALL EASEMENTS, SERVITUDES AND PRIVATE RIGHTS ARE PROPOSED TO BE EXTINGUISHED, SO FAR AS THEIR CONTINUED EXERCISE WOULD BE INCONSISTENT WITH THE EXERCISE OF THE RIGHTS AND RESTRICTIONS PROPOSED TO BE ACQUIRED BY THE UNDERTAKER ON LAND COLOURED BLUE ON THESE LAND PLANS UNLESS STATED OTHERWISE IN THE BOOK OF REFERENCE. ALL EASEMENTS, SERVITUDES AND PRIVATE RIGHTS ARE PROPOSED TO BE SUSPENDED WHILE THE UNDERTAKER IS IN TEMPORARY POSSESSION OF THE LAND COLOURED GREEN ON THESE LAND PLANS UNLESS STATED OTHERWISE IN THE BOOK OF REFERENCE.
3. THIS DRAWING IS TO BE READ IN CONJUNCTION WITH ALL OTHER PLANS AND DOCUMENTATION, IN PARTICULAR THE WORKS PLANS AND THE BOOK OF REFERENCE.

LEGEND

- ORDER LIMITS
- EXISTING PUBLIC RIGHT OF WAY
- PARISH BOUNDARY
- PLOT REFERENCE NUMBER
- LAND TO BE ACQUIRED PERMANENTLY
- LAND TO BE USED TEMPORARILY
- LAND TO BE USED TEMPORARILY AND RIGHTS TO BE ACQUIRED PERMANENTLY

	By	SC		
	By	SC		
First Revision	By	SC	20/09/2024	C01
Revision Details	By		Date	Suffix
	Check			

Purpose of Issue: DCO APPLICATION

Client: Gloucestershire County Council

Development Consent Order Number: TR010063

Project Title: M5 JUNCTION 10 IMPROVEMENTS SCHEME

Development Consent Order Drawing Number: TR010063/APP/2.2

Drawing Title: LAND PLANS REGULATION 5(2)(i) SHEET 5A OF 16

Designed:	Drawn:	Checked:	Date:
--	SC	LE	20/09/2024

Internal Project Number:	Suitability:
J0041885-24-051	DCO Submission

Scale @ A3:	Zone:
1:2,500	Whole Site

THIS DOCUMENT HAS BEEN PREPARED PURSUANT TO AND SUBJECT TO THE TERMS OF CARTER JONAS' APPOINTMENT BY ITS CLIENT. CARTER JONAS ACCEPTS NO LIABILITY FOR ANY USE OF THIS DOCUMENT OTHER THAN BY ITS ORIGINAL CLIENT OR FOLLOWING CARTER JONAS' EXPRESS AGREEMENT TO SUCH USE. AND ONLY FOR THE PURPOSES FOR WHICH IT WAS PREPARED AND PROVIDED

	Rev:
	C01

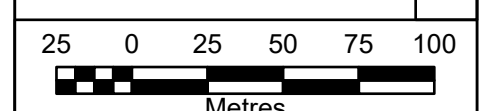



Boddington Coppice

GLOUCESTERSHIRE COUNTY COUNCIL
PARISH OF BODDINGTON

FOR CONTINUATION REFER TO SHEET 6

INSET I

INSET I
SCALE@1:200

FOR CONTINUATION REFER TO SHEET 6

INSET K
SCALE@1:200

INSET J
SCALE@1:100

FOR CONTINUATION REFER TO SHEET 8

FOR CONTINUATION REFER TO SHEET 16

NOTES:

1. ALL DIMENSIONS ARE IN METRES UNLESS STATED OTHERWISE.
2. ALL EASEMENTS, SERVITUDES AND PRIVATE RIGHTS ARE PROPOSED TO BE EXTINGUISHED ON LAND, COLOURED PINK ON THESE LAND PLANS UNLESS STATED OTHERWISE IN THE BOOK OF REFERENCE. ALL EASEMENTS, SERVITUDES AND PRIVATE RIGHTS ARE PROPOSED TO BE EXTINGUISHED, SO FAR AS THEIR CONTINUED EXERCISE WOULD BE INCONSISTENT WITH THE EXERCISE OF THE RIGHTS AND RESTRICTIONS PROPOSED TO BE ACQUIRED BY THE UNDERTAKER ON LAND COLOURED BLUE ON THESE LAND PLANS UNLESS STATED OTHERWISE IN THE BOOK OF REFERENCE. ALL EASEMENTS, SERVITUDES AND PRIVATE RIGHTS ARE PROPOSED TO BE SUSPENDED WHILE THE UNDERTAKER IS IN TEMPORARY POSSESSION OF THE LAND COLOURED GREEN ON THESE LAND PLANS UNLESS STATED OTHERWISE IN THE BOOK OF REFERENCE.
3. THIS DRAWING IS TO BE READ IN CONJUNCTION WITH ALL OTHER PLANS AND DOCUMENTATION, IN PARTICULAR THE WORKS PLANS AND THE BOOK OF REFERENCE.

LEGEND

- ORDER LIMITS
- EXISTING PUBLIC RIGHT OF WAY
- PARISH BOUNDARY
- PLOT REFERENCE NUMBER
- LAND TO BE ACQUIRED PERMANENTLY
- LAND TO BE USED TEMPORARILY
- LAND TO BE USED TEMPORARILY AND RIGHTS TO BE ACQUIRED PERMANENTLY

Revision	By	Date	Suffix
Second Revision	SC	19/02/2024	C02
Third Revision	SC	24/07/2024	C03
Fourth Revision	SC	20/09/2024	C04
Revision Details	By	Date	Suffix
	Check		

Purpose of Issue: DCO APPLICATION

Client: Gloucestershire County Council

Development Consent Order Number: TR010063

Project Title: M5 JUNCTION 10 IMPROVEMENTS SCHEME

Development Consent Order Drawing Number: TR010063/APP/2.2

Drawing Title: LAND PLANS REGULATION 5(2)(i) SHEET 7 OF 16

Designed: --	Drawn: SC	Checked: LE	Date: 20/09/2024
--------------	-----------	-------------	------------------

Internal Project Number: J0041885-24-07k	Suitability: DCO Submission
--	-----------------------------

Scale @ A3: 1:2,500	Zone: Whole Site
---------------------	------------------

THIS DOCUMENT HAS BEEN PREPARED PURSUANT TO AND SUBJECT TO THE TERMS OF CARTER JONAS' APPOINTMENT BY ITS CLIENT. CARTER JONAS ACCEPTS NO LIABILITY FOR ANY USE OF THIS DOCUMENT OTHER THAN BY ITS ORIGINAL CLIENT OR FOLLOWING CARTER JONAS' EXPRESS AGREEMENT TO SUCH USE, AND ONLY FOR THE PURPOSES FOR WHICH IT WAS PREPARED AND PROVIDED

Rev: C04

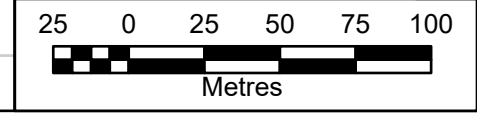



FOR CONTINUATION REFER TO SHEET 7

GLOUCESTERSHIRE COUNTY COUNCIL
PARISH OF BODDINGTON

GLOUCESTERSHIRE COUNTY COUNCIL
PARISH OF STAVERTON

8/1a

8/1b

M5

29.6m

1.22m RH

32.2m

FOR CONTINUATION REFER TO SHEET 9

NOTES:

1. ALL DIMENSIONS ARE IN METRES UNLESS STATED OTHERWISE.
2. ALL EASEMENTS, SERVITUDES AND PRIVATE RIGHTS ARE PROPOSED TO BE EXTINGUISHED ON LAND, COLOURED PINK ON THESE LAND PLANS UNLESS STATED OTHERWISE IN THE BOOK OF REFERENCE. ALL EASEMENTS, SERVITUDES AND PRIVATE RIGHTS ARE PROPOSED TO BE EXTINGUISHED, SO FAR AS THEIR CONTINUED EXERCISE WOULD BE INCONSISTENT WITH THE EXERCISE OF THE RIGHTS AND RESTRICTIONS PROPOSED TO BE ACQUIRED BY THE UNDERTAKER ON LAND COLOURED BLUE ON THESE LAND PLANS UNLESS STATED OTHERWISE IN THE BOOK OF REFERENCE. ALL EASEMENTS, SERVITUDES AND PRIVATE RIGHTS ARE PROPOSED TO BE SUSPENDED WHILE THE UNDERTAKER IS IN TEMPORARY POSSESSION OF THE LAND COLOURED GREEN ON THESE LAND PLANS UNLESS STATED OTHERWISE IN THE BOOK OF REFERENCE.
3. THIS DRAWING IS TO BE READ IN CONJUNCTION WITH ALL OTHER PLANS AND DOCUMENTATION, IN PARTICULAR THE WORKS PLANS AND THE BOOK OF REFERENCE.

LEGEND

- ORDER LIMITS
- EXISTING PUBLIC RIGHT OF WAY
- PARISH BOUNDARY
- PLOT REFERENCE NUMBER
- LAND TO BE ACQUIRED PERMANENTLY
- LAND TO BE USED TEMPORARILY
- LAND TO BE USED TEMPORARILY AND RIGHTS TO BE ACQUIRED PERMANENTLY

First Revision	By SC	29/02/2024	C01
Second Revision	By SC	24/07/2024	C02
Revision Details	By Check	Date	Suffix

Purpose of Issue:
DCO APPLICATION

Client: Gloucestershire County Council

Development Consent Order Number:
TR010063

Project Title:
**M5 JUNCTION 10
IMPROVEMENTS SCHEME**

Development Consent Order Drawing Number:
TR010063/APP/2.2

Drawing Title:
**LAND PLANS
REGULATION 5(2)(i)
SHEET 8 OF 16**

Designed: --	Drawn: SC	Checked: LE	Date: 24/07/2024
-----------------	--------------	----------------	---------------------

Internal Project Number:
J0041885-24-08f

Suitability:
DCO Submission

Scale @ A3:
1:2,500

Zone:
Whole Site

THIS DOCUMENT HAS BEEN PREPARED PURSUANT TO AND SUBJECT TO THE TERMS OF CARTER JONAS' APPOINTMENT BY ITS CLIENT. CARTER JONAS ACCEPTS NO LIABILITY FOR ANY USE OF THIS DOCUMENT OTHER THAN BY ITS ORIGINAL CLIENT OR FOLLOWING CARTER JONAS' EXPRESS AGREEMENT TO SUCH USE, AND ONLY FOR THE PURPOSES FOR WHICH IT WAS PREPARED AND PROVIDED

Rev: C02

25 0 25 50 75 100
Metres

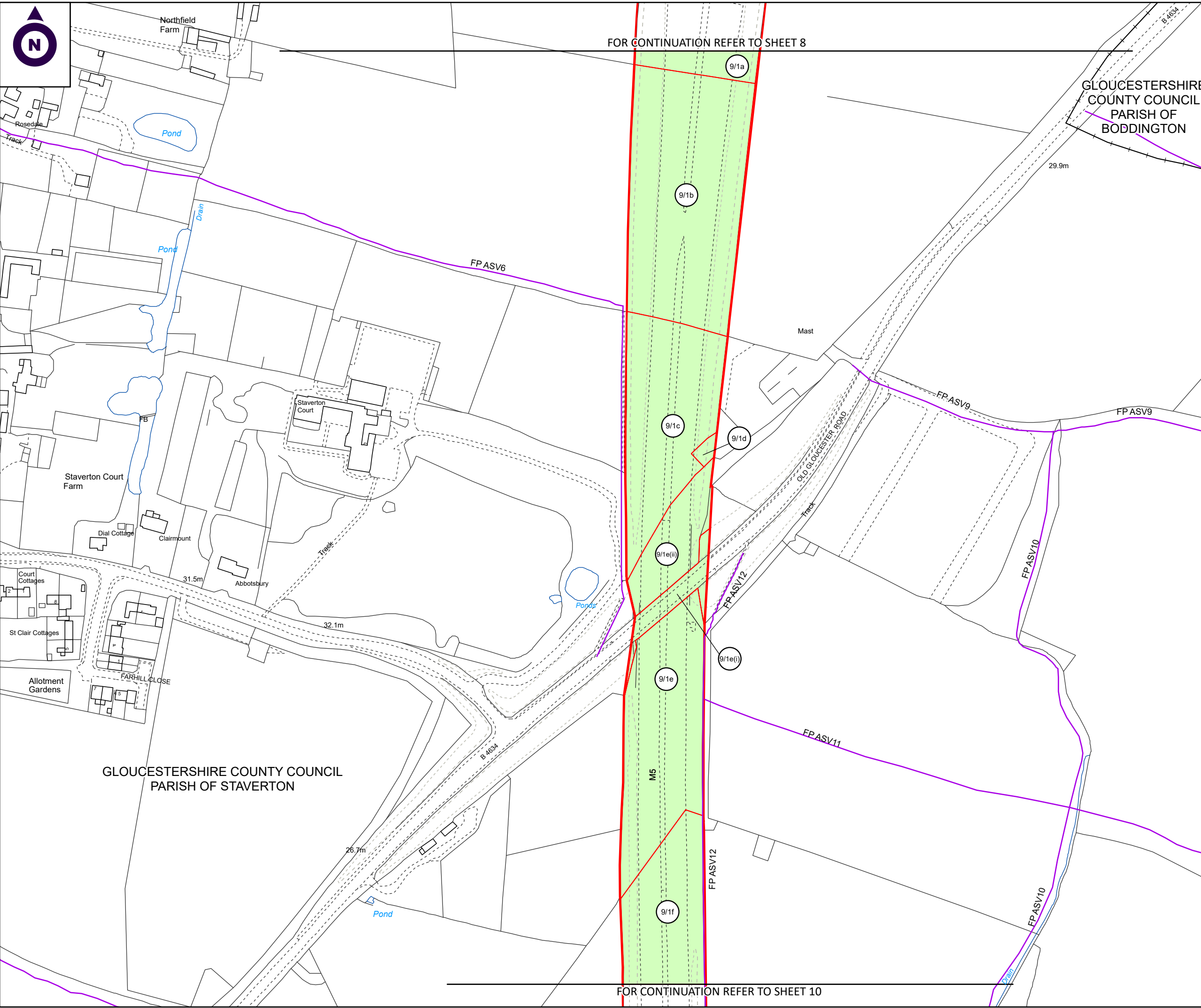

FOR CONTINUATION REFER TO SHEET 8

GLOUCESTERSHIRE
COUNTY COUNCIL
PARISH OF
BODDINGTON

NOTES:
 1. ALL DIMENSIONS ARE IN METRES UNLESS STATED OTHERWISE.
 2. ALL EASEMENTS, SERVITUDES AND PRIVATE RIGHTS ARE PROPOSED TO BE EXTINGUISHED ON LAND COLOURED PINK ON THESE LAND PLANS UNLESS STATED OTHERWISE IN THE BOOK OF REFERENCE. ALL EASEMENTS, SERVITUDES AND PRIVATE RIGHTS ARE PROPOSED TO BE EXTINGUISHED, SO FAR AS THEIR CONTINUED EXERCISE WOULD BE INCONSISTENT WITH THE EXERCISE OF THE RIGHTS AND RESTRICTIONS PROPOSED TO BE ACQUIRED BY THE UNDERTAKER ON LAND COLOURED BLUE ON THESE LAND PLANS UNLESS STATED OTHERWISE IN THE BOOK OF REFERENCE. ALL EASEMENTS, SERVITUDES AND PRIVATE RIGHTS ARE PROPOSED TO BE SUSPENDED WHILE THE UNDERTAKER IS IN TEMPORARY POSSESSION OF THE LAND COLOURED GREEN ON THESE LAND PLANS UNLESS STATED OTHERWISE IN THE BOOK OF REFERENCE.
 3. THIS DRAWING IS TO BE READ IN CONJUNCTION WITH ALL OTHER PLANS AND DOCUMENTATION, IN PARTICULAR THE WORKS PLANS AND THE BOOK OF REFERENCE.

LEGEND

- EXISTING PUBLIC RIGHT OF WAY
- PARISH BOUNDARY
- PLOT REFERENCE NUMBER
- LAND TO BE ACQUIRED PERMANENTLY
- LAND TO BE USED TEMPORARILY
- LAND TO BE USED TEMPORARILY AND RIGHTS TO BE ACQUIRED PERMANENTLY

First Revision	By SC	29/02/2024	C01
Second Revision	By SC	24/07/2024	C02
Revision Details	By Check	Date	Suffix

Purpose of Issue:
DCO APPLICATION

Client: Gloucestershire County Council

Development Consent Order Number:
TR010063

Project Title:
M5 JUNCTION 10 IMPROVEMENTS SCHEME

Development Consent Order Drawing Number:
TR010063/APP/2.2

Drawing Title:
LAND PLANS REGULATION 5(2)(i) SHEET 9 OF 16

Designed: --	Drawn: SC	Checked: LE	Date: 24/07/2024
-----------------	--------------	----------------	---------------------

Internal Project Number: J0041885-24-09g	Suitability: DCO Submission
---	--------------------------------

Scale @ A3: 1:2,500	Zone: Whole Site
------------------------	---------------------

THIS DOCUMENT HAS BEEN PREPARED PURSUANT TO AND SUBJECT TO THE TERMS OF CARTER JONAS' APPOINTMENT BY ITS CLIENT. CARTER JONAS ACCEPTS NO LIABILITY FOR ANY USE OF THIS DOCUMENT OTHER THAN BY ITS ORIGINAL CLIENT OR FOLLOWING CARTER JONAS' EXPRESS AGREEMENT TO SUCH USE, AND ONLY FOR THE PURPOSES FOR WHICH IT WAS PREPARED AND PROVIDED

Rev: C02

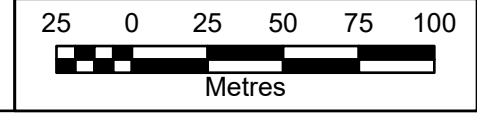

GLOUCESTERSHIRE COUNTY COUNCIL
PARISH OF STAVERTON

FOR CONTINUATION REFER TO SHEET 10



FOR CONTINUATION REFER TO SHEET 9

NOTES:

1. ALL DIMENSIONS ARE IN METRES UNLESS STATED OTHERWISE.
2. ALL EASEMENTS, SERVITUDES AND PRIVATE RIGHTS ARE PROPOSED TO BE EXTINGUISHED ON LAND, COLOURED PINK ON THESE LAND PLANS UNLESS STATED OTHERWISE IN THE BOOK OF REFERENCE. ALL EASEMENTS, SERVITUDES AND PRIVATE RIGHTS ARE PROPOSED TO BE EXTINGUISHED, SO FAR AS THEIR CONTINUED EXERCISE WOULD BE INCONSISTENT WITH THE EXERCISE OF THE RIGHTS AND RESTRICTIONS PROPOSED TO BE ACQUIRED BY THE UNDERTAKER ON LAND COLOURED BLUE ON THESE LAND PLANS UNLESS STATED OTHERWISE IN THE BOOK OF REFERENCE. ALL EASEMENTS, SERVITUDES AND PRIVATE RIGHTS ARE PROPOSED TO BE SUSPENDED WHILE THE UNDERTAKER IS IN TEMPORARY POSSESSION OF THE LAND COLOURED GREEN ON THESE LAND PLANS UNLESS STATED OTHERWISE IN THE BOOK OF REFERENCE.
3. THIS DRAWING IS TO BE READ IN CONJUNCTION WITH ALL OTHER PLANS AND DOCUMENTATION, IN PARTICULAR THE WORKS PLANS AND THE BOOK OF REFERENCE.

LEGEND

- ORDER LIMITS
- EXISTING PUBLIC RIGHT OF WAY
- PARISH BOUNDARY
- PLOT REFERENCE NUMBER
- LAND TO BE ACQUIRED PERMANENTLY
- LAND TO BE USED TEMPORARILY
- LAND TO BE USED TEMPORARILY AND RIGHTS TO BE ACQUIRED PERMANENTLY

First Revision	By SC	29/02/2024	C01
Second Revision	By SC	24/07/2024	C02
Revision Details	By	Date	Suffix
	Check		

Purpose of Issue: DCO APPLICATION

Client: Gloucestershire County Council

Development Consent Order Number: TR010063

Project Title:
M5 JUNCTION 10 IMPROVEMENTS SCHEME

Development Consent Order Drawing Number: TR010063/APP/2.2

Drawing Title:
LAND PLANS REGULATION 5(2)(i) SHEET 10 OF 16

Designed:	Drawn:	Checked:	Date:
--	SC	LE	24/07/2024

Internal Project Number:	Suitability:
J0041885-24-10h	DCO Submission

Scale @ A3:	Zone:
1:2,500	Whole Site

THIS DOCUMENT HAS BEEN PREPARED PURSUANT TO AND SUBJECT TO THE TERMS OF CARTER JONAS' APPOINTMENT BY ITS CLIENT. CARTER JONAS ACCEPTS NO LIABILITY FOR ANY USE OF THIS DOCUMENT OTHER THAN BY ITS ORIGINAL CLIENT OR FOLLOWING CARTER JONAS' EXPRESS AGREEMENT TO SUCH USE, AND ONLY FOR THE PURPOSES FOR WHICH IT WAS PREPARED AND PROVIDED

Rev:
C02

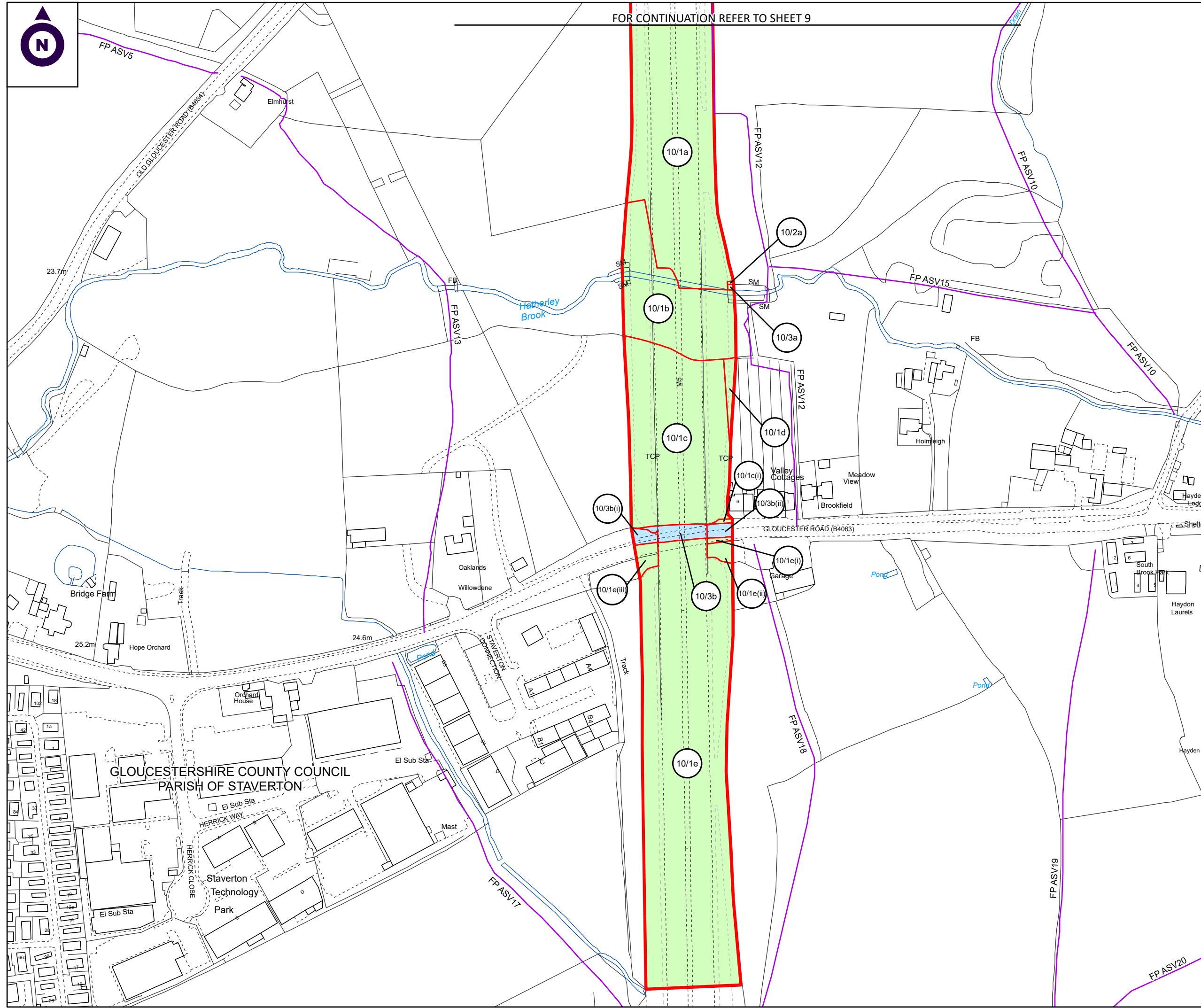
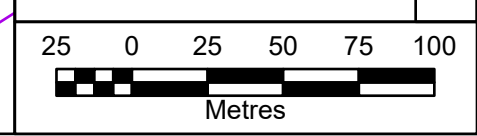

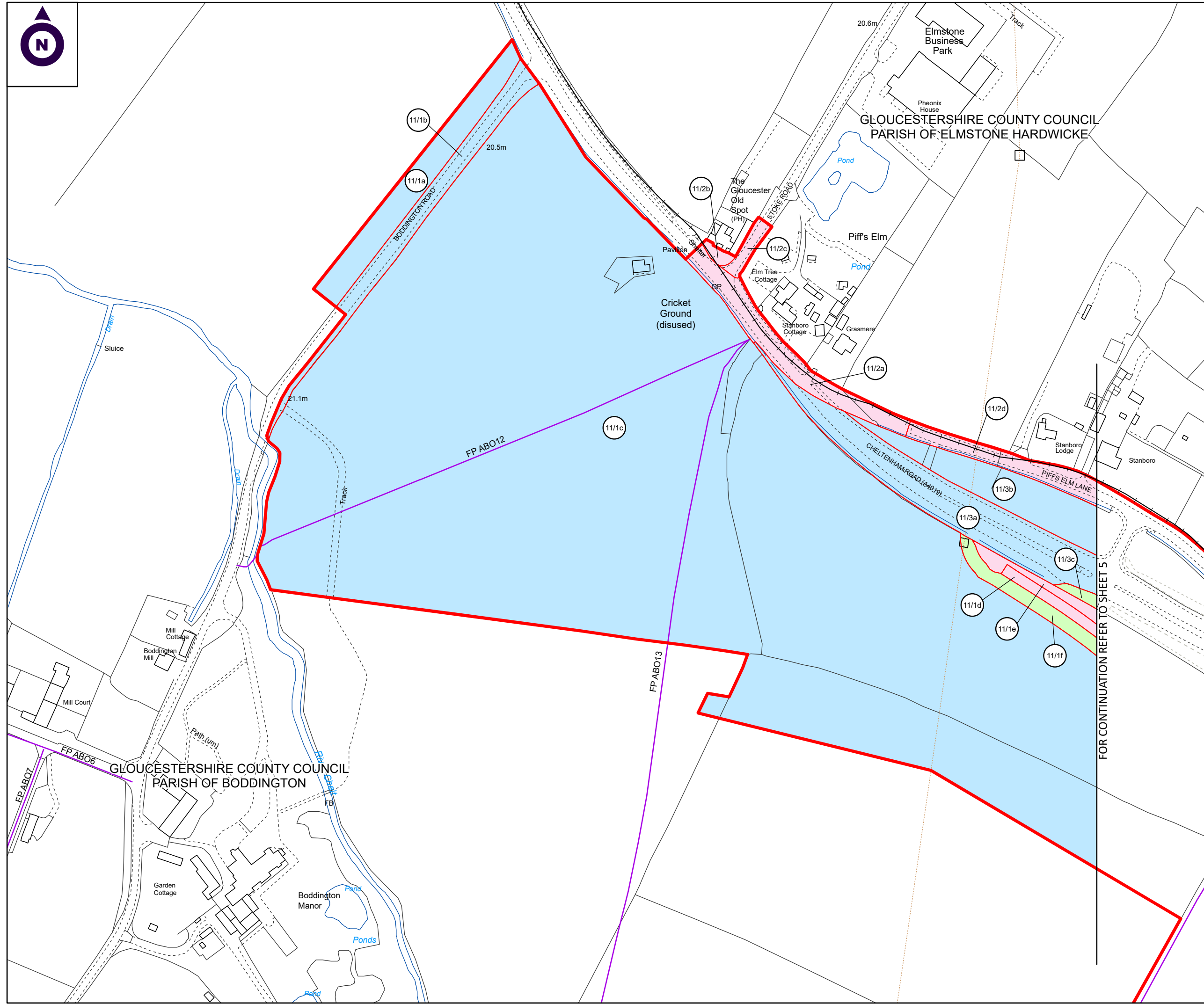

NOTES:

1. ALL DIMENSIONS ARE IN METRES UNLESS STATED OTHERWISE.
2. ALL EASEMENTS, SERVITUDES AND PRIVATE RIGHTS ARE PROPOSED TO BE EXTINGUISHED ON LAND, COLOURED PINK ON THESE LAND PLANS UNLESS STATED OTHERWISE IN THE BOOK OF REFERENCE. ALL EASEMENTS, SERVITUDES AND PRIVATE RIGHTS ARE PROPOSED TO BE EXTINGUISHED, SO FAR AS THEIR CONTINUED EXERCISE WOULD BE INCONSISTENT WITH THE EXERCISE OF THE RIGHTS AND RESTRICTIONS PROPOSED TO BE ACQUIRED BY THE UNDERTAKER ON LAND COLOURED BLUE ON THESE LAND PLANS UNLESS STATED OTHERWISE IN THE BOOK OF REFERENCE. ALL EASEMENTS, SERVITUDES AND PRIVATE RIGHTS ARE PROPOSED TO BE SUSPENDED WHILE THE UNDERTAKER IS IN TEMPORARY POSSESSION OF THE LAND COLOURED GREEN ON THESE LAND PLANS UNLESS STATED OTHERWISE IN THE BOOK OF REFERENCE.
3. THIS DRAWING IS TO BE READ IN CONJUNCTION WITH ALL OTHER PLANS AND DOCUMENTATION, IN PARTICULAR THE WORKS PLANS AND THE BOOK OF REFERENCE.

LEGEND

- ORDER LIMITS
- EXISTING PUBLIC RIGHT OF WAY
- PARISH BOUNDARY
- PLOT REFERENCE NUMBER
- LAND TO BE ACQUIRED PERMANENTLY
- LAND TO BE USED TEMPORARILY
- LAND TO BE USED TEMPORARILY AND RIGHTS TO BE ACQUIRED PERMANENTLY

First Revision	By SC	29/02/2024	C01
Second Revision	By SC	24/07/2024	C02
Revision Details	By	Date	Suffix
	Check		

Purpose of Issue: **DCO APPLICATION**

Client: Gloucestershire County Council

Development Consent Order Number: **TR010063**

Project Title: **M5 JUNCTION 10 IMPROVEMENTS SCHEME**

Development Consent Order Drawing Number: **TR010063/APP/2.2**

Drawing Title: **LAND PLANS REGULATION 5(2)(i) SHEET 11 OF 16**

Designed: --	Drawn: SC	Checked: LE	Date: 03/09/2024
--------------	-----------	-------------	------------------

Internal Project Number: J0041885-24-11h
 Suitability: DCO Submission

Scale @ A3: 1:2,500
 Zone: Whole Site

THIS DOCUMENT HAS BEEN PREPARED PURSUANT TO AND SUBJECT TO THE TERMS OF CARTER JONAS' APPOINTMENT BY ITS CLIENT. CARTER JONAS ACCEPTS NO LIABILITY FOR ANY USE OF THIS DOCUMENT OTHER THAN BY ITS ORIGINAL CLIENT OR FOLLOWING CARTER JONAS' EXPRESS AGREEMENT TO SUCH USE, AND ONLY FOR THE PURPOSES FOR WHICH IT WAS PREPARED AND PROVIDED

Rev: C02

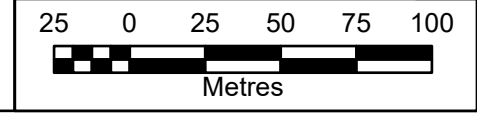

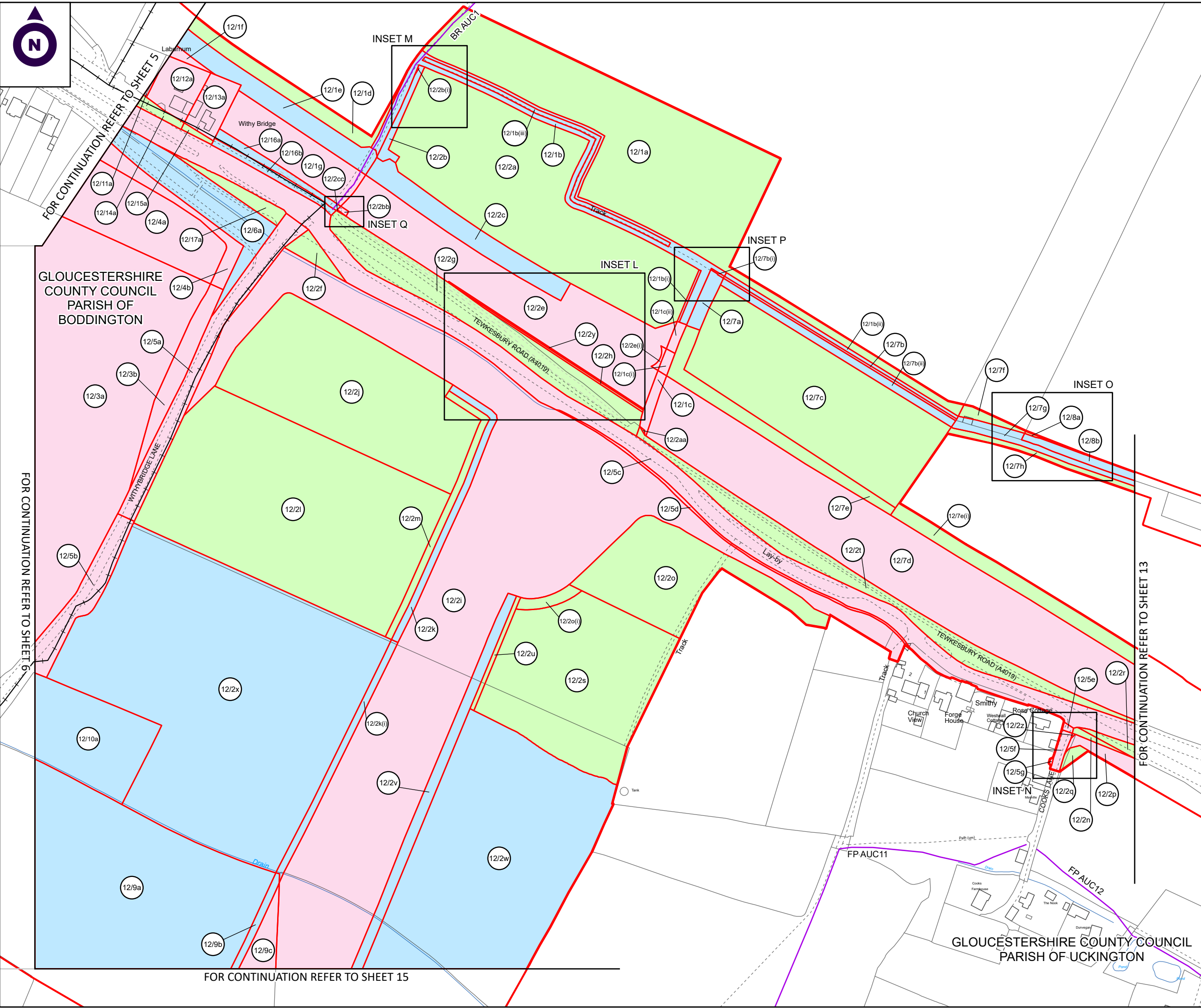

NOTES:

1. ALL DIMENSIONS ARE IN METRES UNLESS STATED OTHERWISE.
2. ALL EASEMENTS, SERVITUDES AND PRIVATE RIGHTS ARE PROPOSED TO BE EXTINGUISHED ON LAND, COLOURED PINK ON THESE LAND PLANS UNLESS STATED OTHERWISE IN THE BOOK OF REFERENCE. ALL EASEMENTS, SERVITUDES AND PRIVATE RIGHTS ARE PROPOSED TO BE EXTINGUISHED, SO FAR AS THEIR CONTINUED EXERCISE WOULD BE INCONSISTENT WITH THE EXERCISE OF THE RIGHTS AND RESTRICTIONS PROPOSED TO BE ACQUIRED BY THE UNDERTAKER ON LAND COLOURED BLUE ON THESE LAND PLANS UNLESS STATED OTHERWISE IN THE BOOK OF REFERENCE. ALL EASEMENTS, SERVITUDES AND PRIVATE RIGHTS ARE PROPOSED TO BE SUSPENDED WHILE THE UNDERTAKER IS IN TEMPORARY POSSESSION OF THE LAND COLOURED GREEN ON THESE LAND PLANS UNLESS STATED OTHERWISE IN THE BOOK OF REFERENCE.
3. THIS DRAWING IS TO BE READ IN CONJUNCTION WITH ALL OTHER PLANS AND DOCUMENTATION, IN PARTICULAR THE WORKS PLANS AND THE BOOK OF REFERENCE.

LEGEND

- ORDER LIMITS
- EXISTING PUBLIC RIGHT OF WAY
- PARISH BOUNDARY
- PLOT REFERENCE NUMBER
- LAND TO BE ACQUIRED PERMANENTLY
- LAND TO BE USED TEMPORARILY AND RIGHTS TO BE ACQUIRED PERMANENTLY
- LAND TO BE USED TEMPORARILY

Revision	By	Date	Suffix
Second Revision	By SC	19/02/2024	C02
Third Revision	By SC	24/07/2024	C03
Fourth Revision	By SC	17/09/2024	C04
Revision Details	By	Date	Suffix
	Check		

Purpose of Issue: **DCO APPLICATION**

Client: Gloucestershire County Council

Development Consent Order Number: **TR010063**

Project Title: **M5 JUNCTION 10 IMPROVEMENTS SCHEME**

Development Consent Order Drawing Number: **TR010063/APP/2.2**

Drawing Title: **LAND PLANS REGULATION 5(2)(i) SHEET 12 OF 16**

Designed: --	Drawn: SC	Checked: LE	Date: 17/09/2024
--------------	-----------	-------------	------------------

Internal Project Number: J0041885-24-12k
 Suitability: DCO Submission

Scale @ A3: 1:2,500
 Zone: Whole Site

THIS DOCUMENT HAS BEEN PREPARED PURSUANT TO AND SUBJECT TO THE TERMS OF CARTER JONAS' APPOINTMENT BY ITS CLIENT. CARTER JONAS ACCEPTS NO LIABILITY FOR ANY USE OF THIS DOCUMENT OTHER THAN BY ITS ORIGINAL CLIENT OR FOLLOWING CARTER JONAS' EXPRESS AGREEMENT TO SUCH USE, AND ONLY FOR THE PURPOSES FOR WHICH IT WAS PREPARED AND PROVIDED

Rev: **C04**

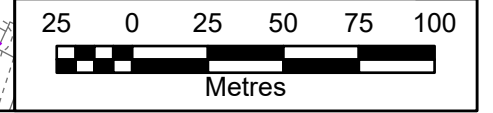



INSET L @ 1:1250

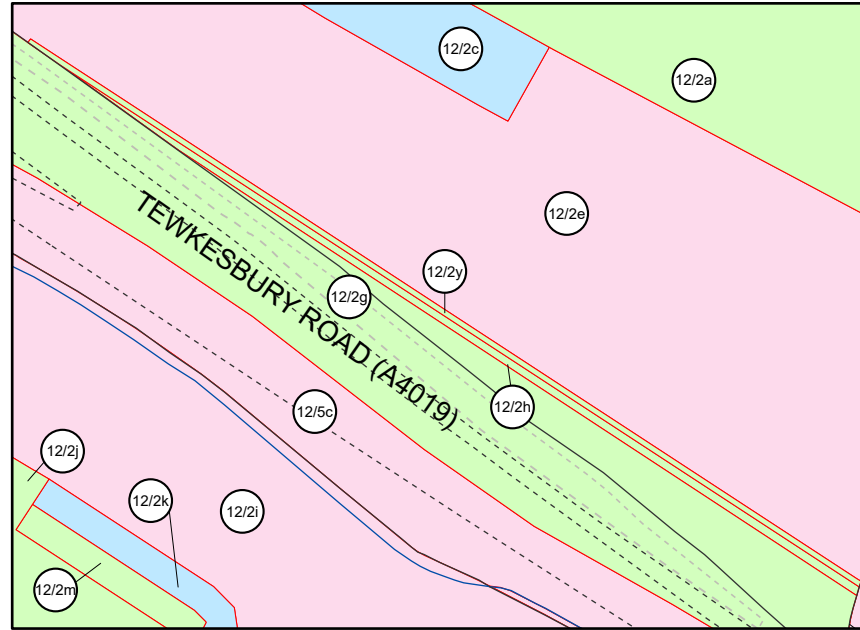

INSET M @ 1:750



INSET N @ 1:500

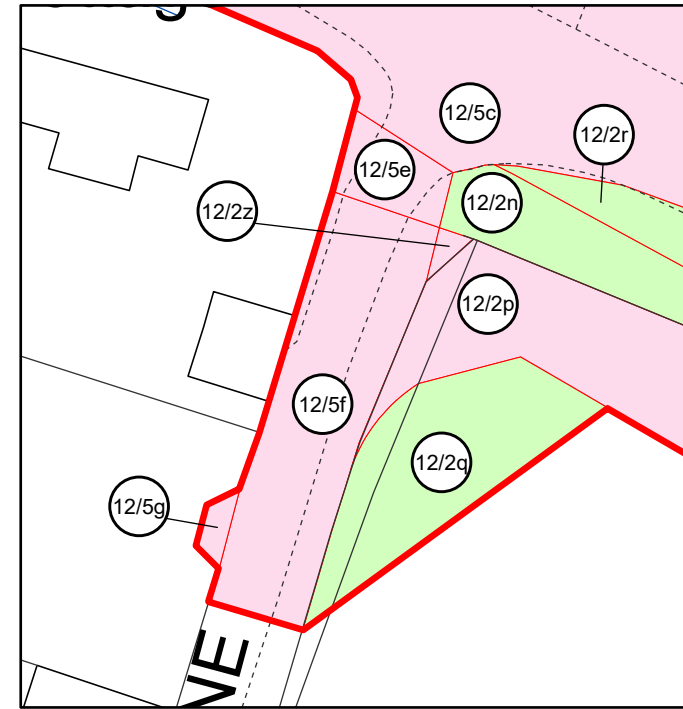

INSET O @ 1:750

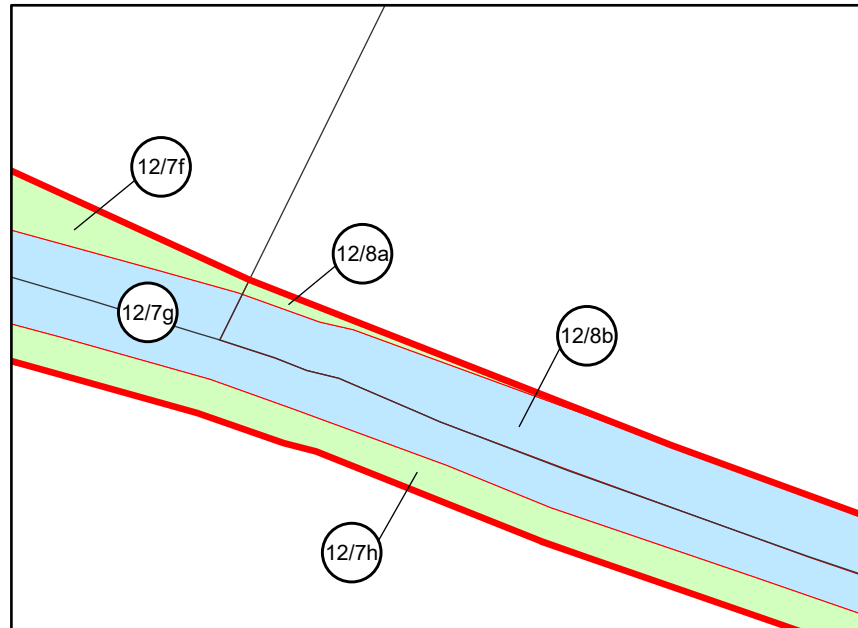

INSET P @ 1:500

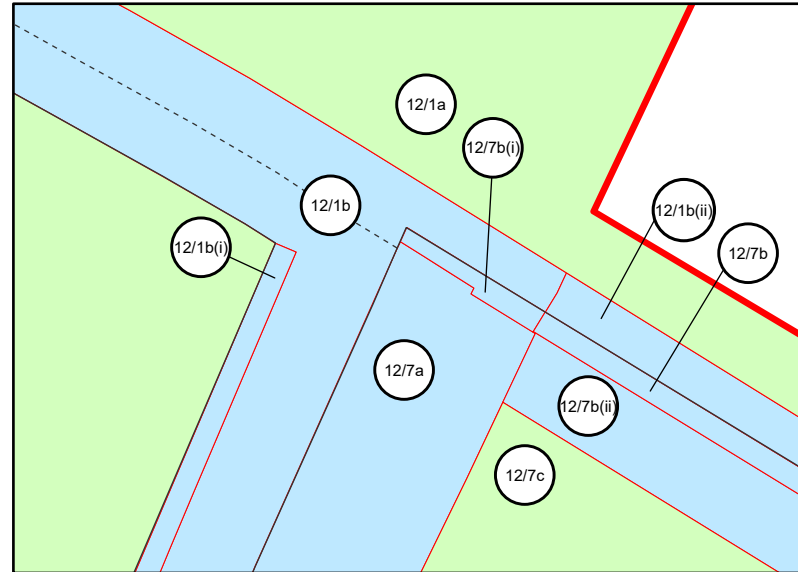

INSET Q @ 1:250

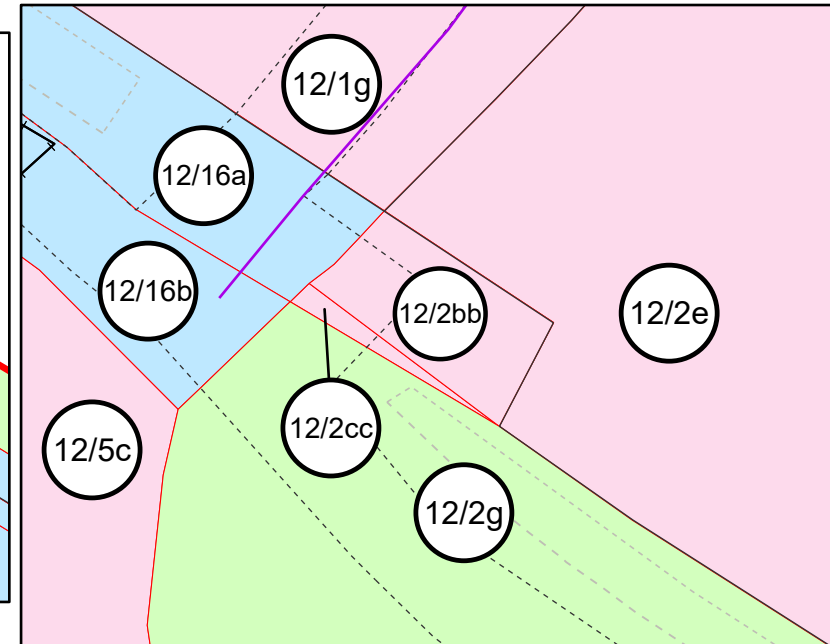

NOTES:

1. ALL DIMENSIONS ARE IN METRES UNLESS STATED OTHERWISE.
2. ALL EASEMENTS, SERVITUDES AND PRIVATE RIGHTS ARE PROPOSED TO BE EXTINGUISHED ON LAND, COLOURED PINK ON THESE LAND PLANS UNLESS STATED OTHERWISE IN THE BOOK OF REFERENCE. ALL EASEMENTS, SERVITUDES AND PRIVATE RIGHTS ARE PROPOSED TO BE EXTINGUISHED, SO FAR AS THEIR CONTINUED EXERCISE WOULD BE INCONSISTENT WITH THE EXERCISE OF THE RIGHTS AND RESTRICTIONS PROPOSED TO BE ACQUIRED BY THE UNDERTAKER ON LAND COLOURED BLUE ON THESE LAND PLANS UNLESS STATED OTHERWISE IN THE BOOK OF REFERENCE. ALL EASEMENTS, SERVITUDES AND PRIVATE RIGHTS ARE PROPOSED TO BE SUSPENDED WHILE THE UNDERTAKER IS IN TEMPORARY POSSESSION OF THE LAND COLOURED GREEN ON THESE LAND PLANS UNLESS STATED OTHERWISE IN THE BOOK OF REFERENCE.
3. THIS DRAWING IS TO BE READ IN CONJUNCTION WITH ALL OTHER PLANS AND DOCUMENTATION, IN PARTICULAR THE WORKS PLANS AND THE BOOK OF REFERENCE.

LEGEND

- ORDER LIMITS
- EXISTING PUBLIC RIGHT OF WAY
- PARISH BOUNDARY
- PLOT REFERENCE NUMBER
- LAND TO BE ACQUIRED PERMANENTLY
- LAND TO BE USED TEMPORARILY
- LAND TO BE USED TEMPORARILY AND RIGHTS TO BE ACQUIRED PERMANENTLY

Revision	By	Date	Suffix
First Revision	SC	21/02/2024	C01
Second Revision	SC	24/07/2024	C02
Third Revision	SC	16/09/2024	C03
Revision Details	By	Date	Suffix
	Check		

Purpose of Issue: DCO APPLICATION

Client: Gloucestershire County Council

Development Consent Order Number: TR010063

Project Title: M5 JUNCTION 10 IMPROVEMENTS SCHEME

Development Consent Order Drawing Number: TR010063/APP/2.2

Drawing Title: LAND PLANS REGULATION 5(2)(i) SHEET 12A OF 16

Designed: --	Drawn: SC	Checked: LE	Date: 16/09/2024
--------------	-----------	-------------	------------------

Internal Project Number: J0041885-24-12Ad	Suitability: DCO Submission
---	-----------------------------

Scale @ A3: Various	Zone: Whole Site
---------------------	------------------

THIS DOCUMENT HAS BEEN PREPARED PURSUANT TO AND SUBJECT TO THE TERMS OF CARTER JONAS' APPOINTMENT BY ITS CLIENT. CARTER JONAS ACCEPTS NO LIABILITY FOR ANY USE OF THIS DOCUMENT OTHER THAN BY ITS ORIGINAL CLIENT OR FOLLOWING CARTER JONAS' EXPRESS AGREEMENT TO SUCH USE, AND ONLY FOR THE PURPOSES FOR WHICH IT WAS PREPARED AND PROVIDED

Rev: C03

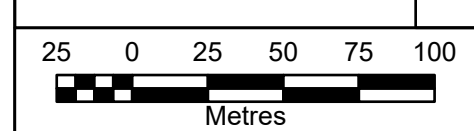



GLoucestershire County Council PARISH OF UCKINGTON

- NOTES:
1. ALL DIMENSIONS ARE IN METRES UNLESS STATED OTHERWISE.
 2. ALL EASEMENTS, SERVITUDES AND PRIVATE RIGHTS ARE PROPOSED TO BE EXTINGUISHED ON LAND, COLOURED PINK ON THESE LAND PLANS UNLESS STATED OTHERWISE IN THE BOOK OF REFERENCE. ALL EASEMENTS, SERVITUDES AND PRIVATE RIGHTS ARE PROPOSED TO BE EXTINGUISHED, SO FAR AS THEIR CONTINUED EXERCISE WOULD BE INCONSISTENT WITH THE EXERCISE OF THE RIGHTS AND RESTRICTIONS PROPOSED TO BE ACQUIRED BY THE UNDERTAKER ON LAND COLOURED BLUE ON THESE LAND PLANS UNLESS STATED OTHERWISE IN THE BOOK OF REFERENCE. ALL EASEMENTS, SERVITUDES AND PRIVATE RIGHTS ARE PROPOSED TO BE SUSPENDED WHILE THE UNDERTAKER IS IN TEMPORARY POSSESSION OF THE LAND COLOURED GREEN ON THESE LAND PLANS UNLESS STATED OTHERWISE IN THE BOOK OF REFERENCE.
 3. THIS DRAWING IS TO BE READ IN CONJUNCTION WITH ALL OTHER PLANS AND DOCUMENTATION, IN PARTICULAR THE WORKS PLANS AND THE BOOK OF REFERENCE.

LEGEND

- ORDER LIMITS
- EXISTING PUBLIC RIGHT OF WAY
- PARISH BOUNDARY
- PLOT REFERENCE NUMBER
- LAND TO BE ACQUIRED PERMANENTLY
- LAND TO BE USED TEMPORARILY
- LAND TO BE USED TEMPORARILY AND RIGHTS TO BE ACQUIRED PERMANENTLY

Revision Details	By	Date	Suffix
Second Revision	By SC	28/02/2024	C02
Third Revision	By SC	24/07/2024	C03
Fourth Revision	By SC	17/09/2024	C04

Purpose of Issue: **DCO APPLICATION**

Client: Gloucestershire County Council

Development Consent Order Number:
TR010063

Project Title:
M5 JUNCTION 10 IMPROVEMENTS SCHEME

Development Consent Order Drawing Number:
TR010063/APP/2.2

Drawing Title:
LAND PLANS REGULATION 5(2)(i) SHEET 13 OF 16

Designed:	Drawn:	Checked:	Date:
--	SC	LE	17/09/2024

Internal Project Number:	Suitability:
J0041885-24-13j	DCO Submission

Scale @ A3:	Zone:
1:2,500	Whole Site

THIS DOCUMENT HAS BEEN PREPARED PURSUANT TO AND SUBJECT TO THE TERMS OF CARTER JONAS' APPOINTMENT BY ITS CLIENT. CARTER JONAS ACCEPTS NO LIABILITY FOR ANY USE OF THIS DOCUMENT OTHER THAN BY ITS ORIGINAL CLIENT OR FOLLOWING CARTER JONAS' EXPRESS AGREEMENT TO SUCH USE, AND ONLY FOR THE PURPOSES FOR WHICH IT WAS PREPARED AND PROVIDED

Rev:	C04
------	-----

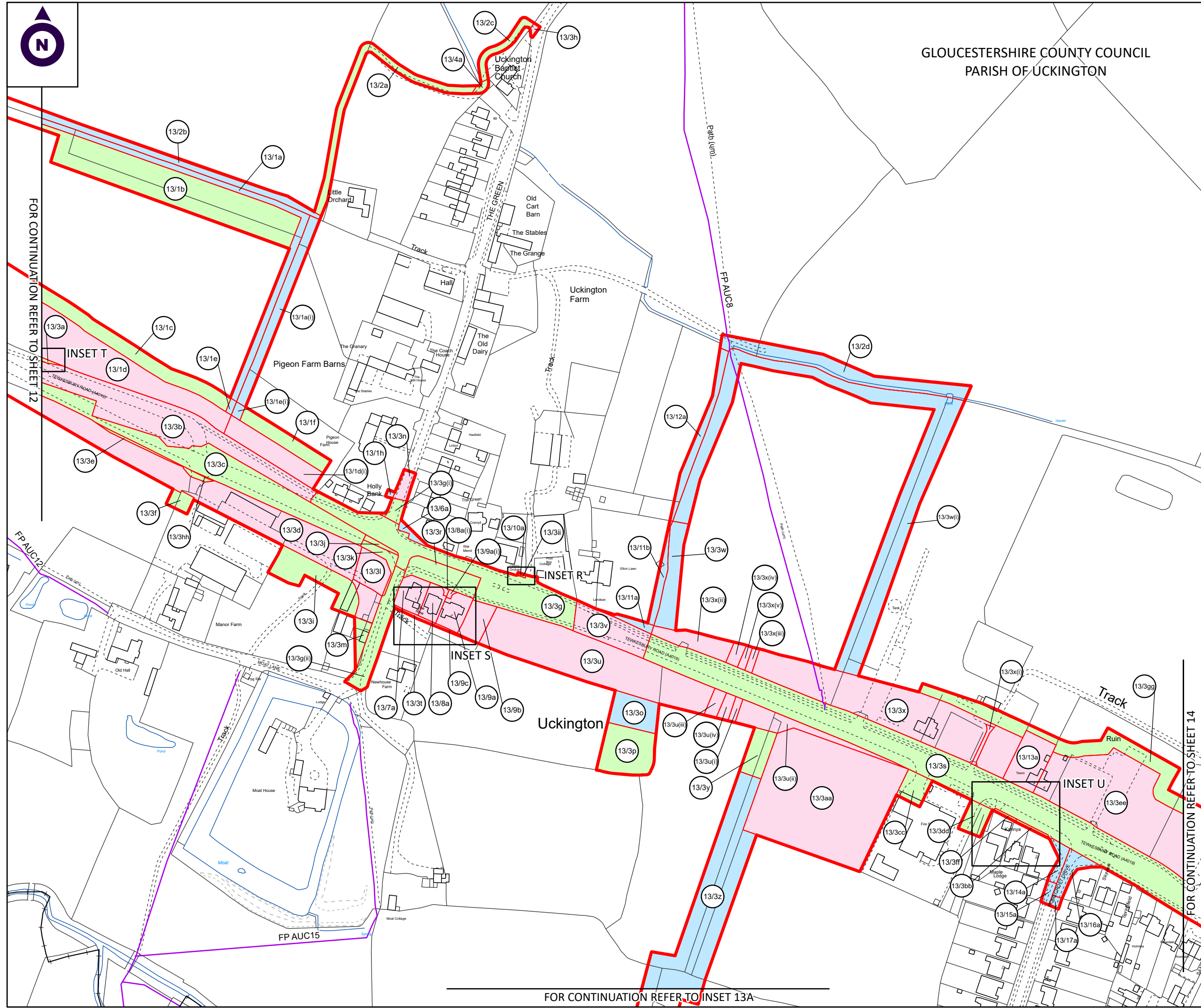
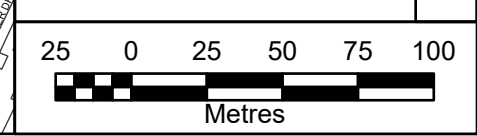

FOR CONTINUATION REFER TO SHEET 12

FP AUC12

FP AUC13

FP AUC14

FP AUC15

FOR CONTINUATION REFER TO INSET 13A

FOR CONTINUATION REFER TO SHEET 14



INSET R @ 1:300

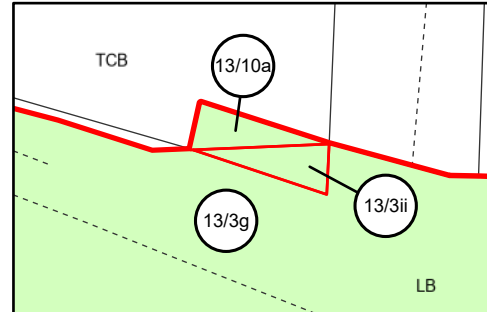

INSET S @ 1:750

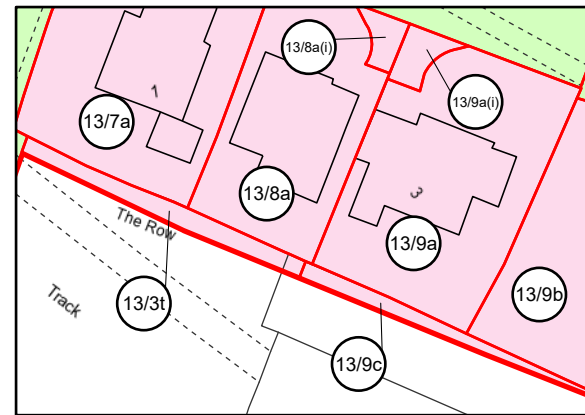

INSET T @ 1:250

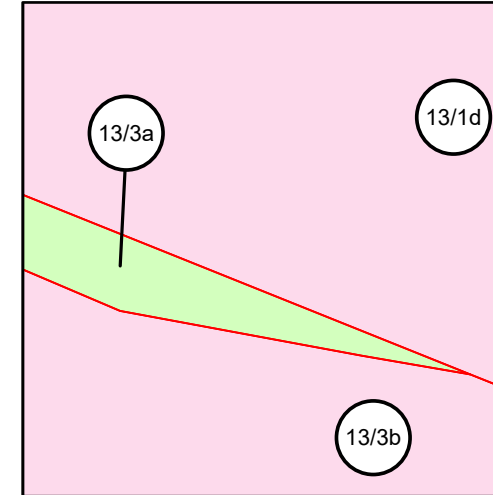

INSET U @ 1:750



INSET 13A @ 1:2500

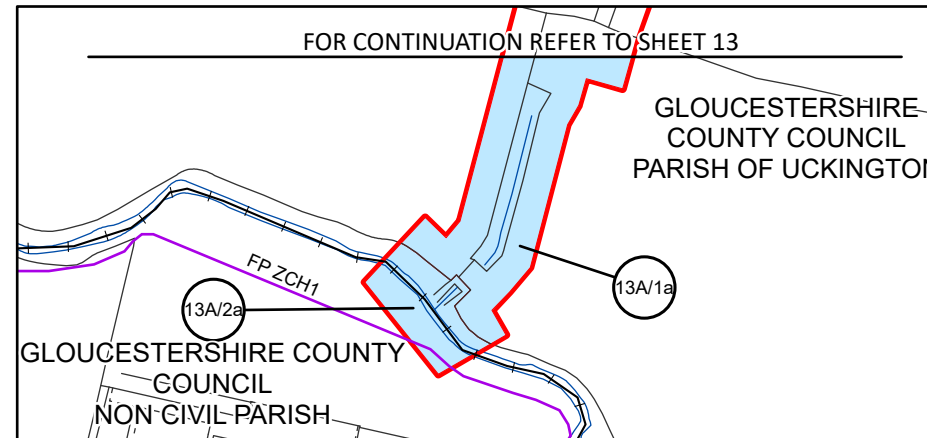

NOTES:

1. ALL DIMENSIONS ARE IN METRES UNLESS STATED OTHERWISE.
2. ALL EASEMENTS, SERVITUDES AND PRIVATE RIGHTS ARE PROPOSED TO BE EXTINGUISHED ON LAND, COLOURED PINK ON THESE LAND PLANS UNLESS STATED OTHERWISE IN THE BOOK OF REFERENCE. ALL EASEMENTS, SERVITUDES AND PRIVATE RIGHTS ARE PROPOSED TO BE EXTINGUISHED, SO FAR AS THEIR CONTINUED EXERCISE WOULD BE INCONSISTENT WITH THE EXERCISE OF THE RIGHTS AND RESTRICTIONS PROPOSED TO BE ACQUIRED BY THE UNDERTAKER ON LAND COLOURED BLUE ON THESE LAND PLANS UNLESS STATED OTHERWISE IN THE BOOK OF REFERENCE. ALL EASEMENTS, SERVITUDES AND PRIVATE RIGHTS ARE PROPOSED TO BE SUSPENDED WHILE THE UNDERTAKER IS IN TEMPORARY POSSESSION OF THE LAND COLOURED GREEN ON THESE LAND PLANS UNLESS STATED OTHERWISE IN THE BOOK OF REFERENCE.
3. THIS DRAWING IS TO BE READ IN CONJUNCTION WITH ALL OTHER PLANS AND DOCUMENTATION, IN PARTICULAR THE WORKS PLANS AND THE BOOK OF REFERENCE.

LEGEND

- ORDER LIMITS
- EXISTING PUBLIC RIGHT OF WAY
- PARISH BOUNDARY
- PLOT REFERENCE NUMBER
- LAND TO BE ACQUIRED PERMANENTLY
- LAND TO BE USED TEMPORARILY
- LAND TO BE USED TEMPORARILY AND RIGHTS TO BE ACQUIRED PERMANENTLY

Revision	By	Date	Suffix
First Revision	SC	28/02/2024	C01
Second Revision	SC	24/07/2024	C02
Third Revision	SC	17/09/2024	C03
Revision Details	By	Date	Suffix
	Check		

Purpose of Issue: DCO APPLICATION

Client: Gloucestershire County Council

Development Consent Order Number: TR010063

Project Title: M5 JUNCTION 10 IMPROVEMENTS SCHEME

Development Consent Order Drawing Number: TR010063/APP/2.2

Drawing Title: LAND PLANS REGULATION 5(2)(i) SHEET 13A OF 16

Designed: --	Drawn: SC	Checked: LE	Date: 17/09/2024
--------------	-----------	-------------	------------------

Internal Project Number: J0041885-24-13-Ab	Suitability: DCO Submission
--	-----------------------------

Scale @ A3: 1:2,500	Zone: Whole Site
---------------------	------------------

THIS DOCUMENT HAS BEEN PREPARED PURSUANT TO AND SUBJECT TO THE TERMS OF CARTER JONAS' APPOINTMENT BY ITS CLIENT. CARTER JONAS ACCEPTS NO LIABILITY FOR ANY USE OF THIS DOCUMENT OTHER THAN BY ITS ORIGINAL CLIENT OR FOLLOWING CARTER JONAS' EXPRESS AGREEMENT TO SUCH USE. AND ONLY FOR THE PURPOSES FOR WHICH IT WAS PREPARED AND PROVIDED

Rev: C03

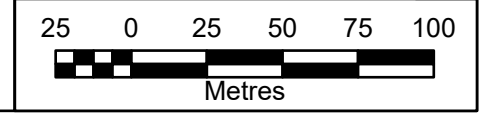



FOR CONTINUATION REFER TO SHEET 13

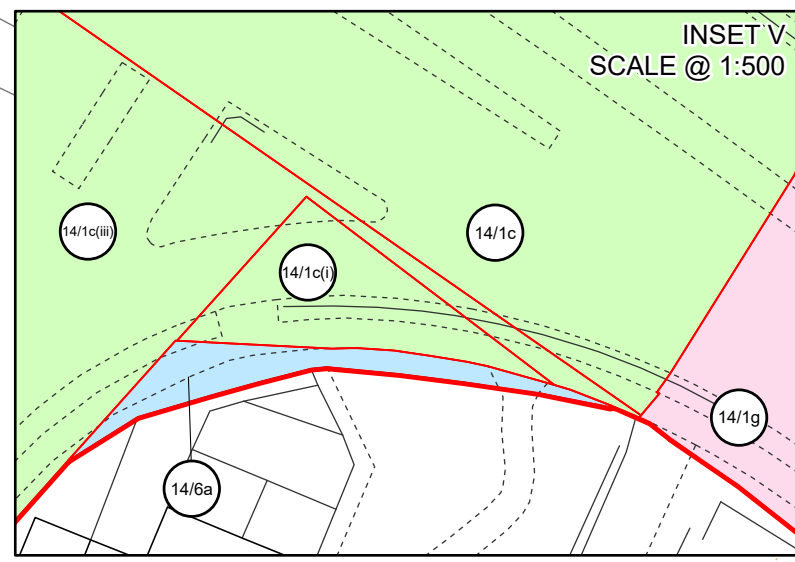

INSET V
SCALE @ 1:500

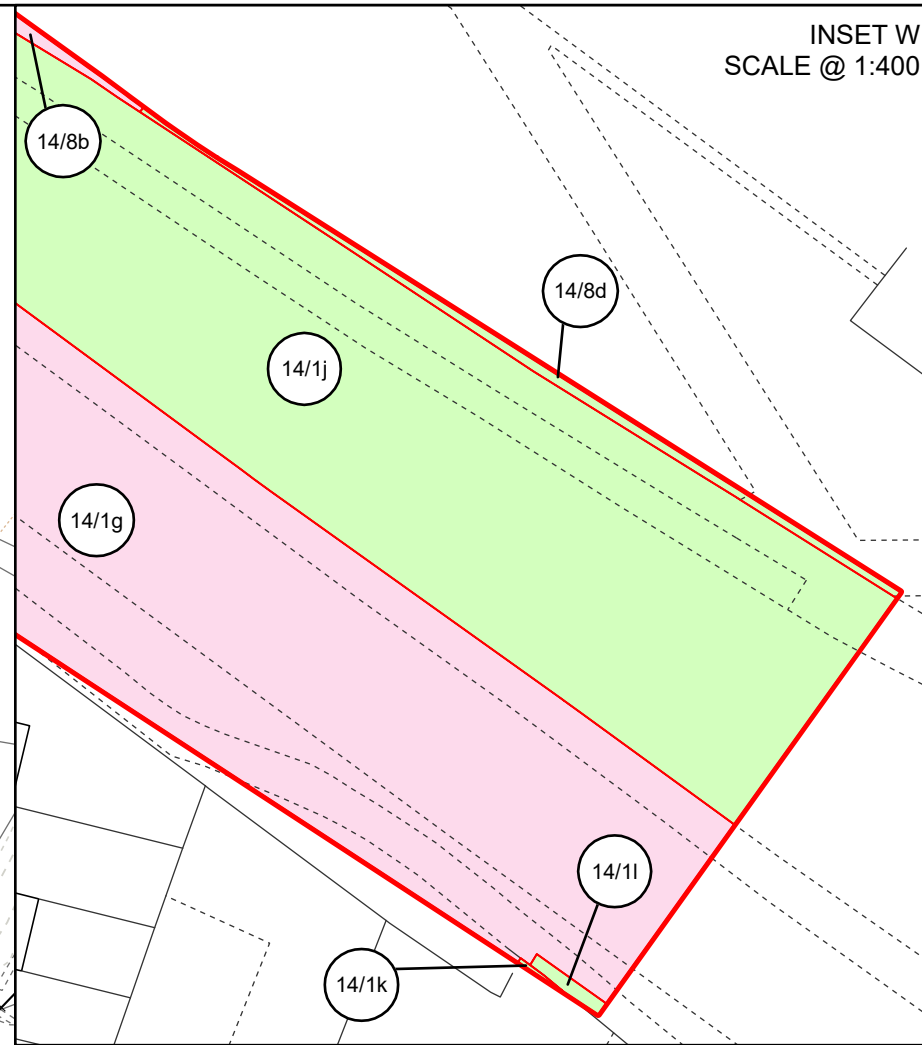

INSET W
SCALE @ 1:400

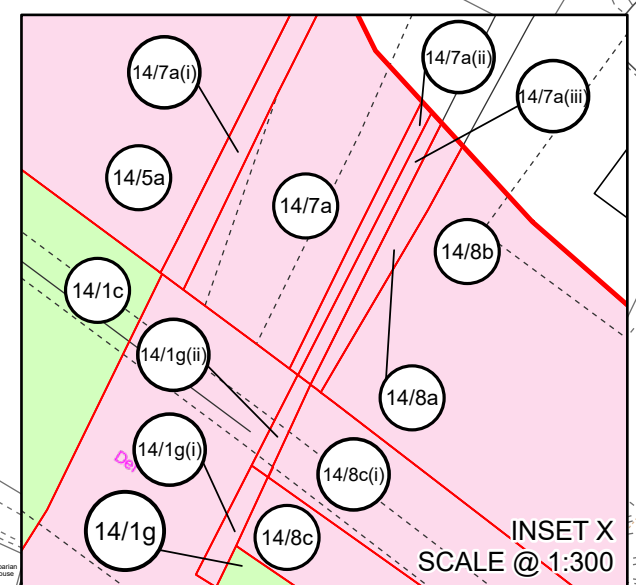

INSET X
SCALE @ 1:300

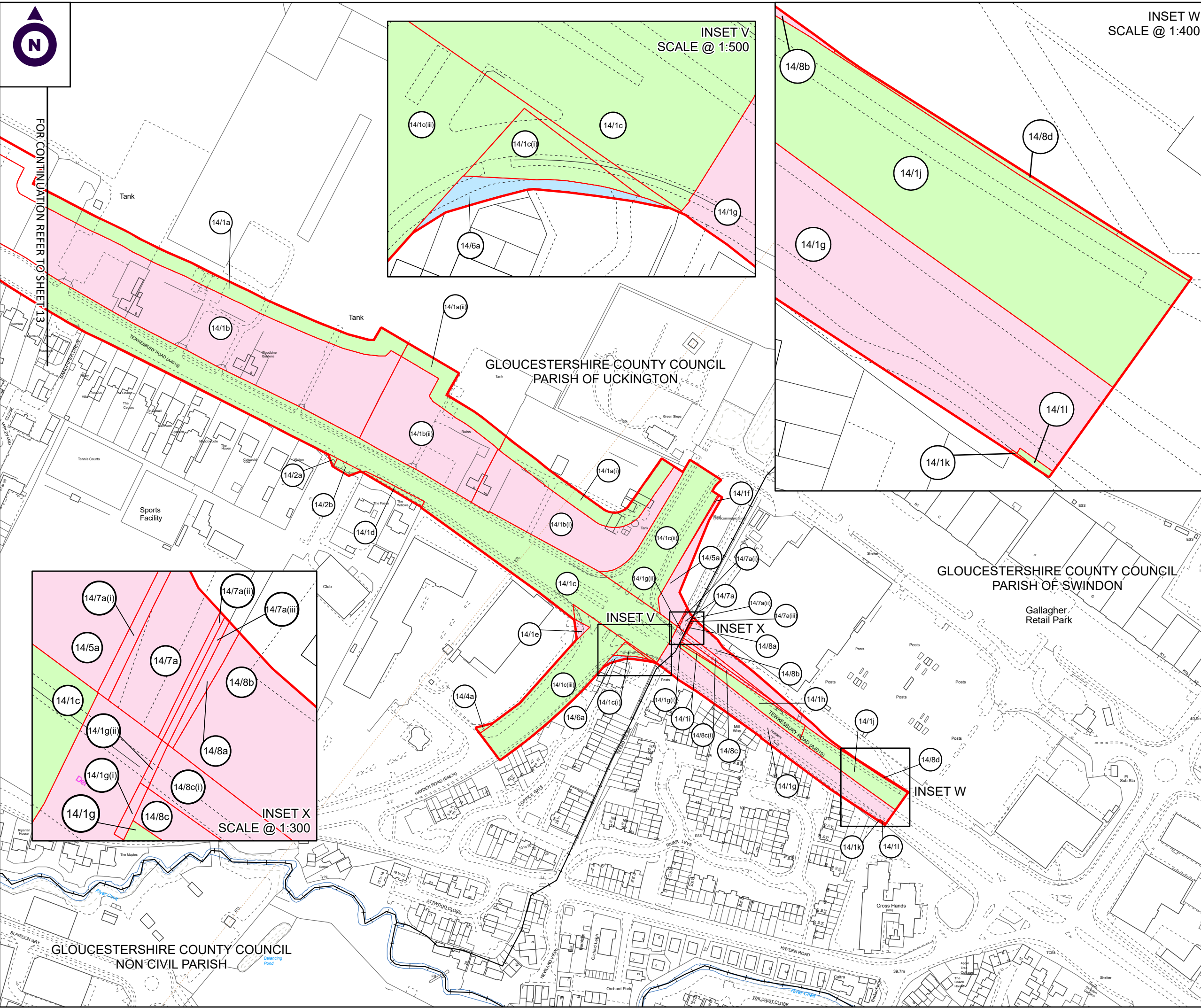

GLoucestershire County Council
PARISH OF UCKINGTON

GLoucestershire County Council
PARISH OF SWINDON

GLoucestershire County Council
NON-CIVIL PARISH

NOTES:

1. ALL DIMENSIONS ARE IN METRES UNLESS STATED OTHERWISE.
2. ALL EASEMENTS, SERVITUDES AND PRIVATE RIGHTS ARE PROPOSED TO BE EXTINGUISHED ON LAND, COLOURED PINK ON THESE LAND PLANS UNLESS STATED OTHERWISE IN THE BOOK OF REFERENCE. ALL EASEMENTS, SERVITUDES AND PRIVATE RIGHTS ARE PROPOSED TO BE EXTINGUISHED, SO FAR AS THEIR CONTINUED EXERCISE WOULD BE INCONSISTENT WITH THE EXERCISE OF THE RIGHTS AND RESTRICTIONS PROPOSED TO BE ACQUIRED BY THE UNDERTAKER ON LAND COLOURED BLUE ON THESE LAND PLANS UNLESS STATED OTHERWISE IN THE BOOK OF REFERENCE. ALL EASEMENTS, SERVITUDES AND PRIVATE RIGHTS ARE PROPOSED TO BE SUSPENDED WHILE THE UNDERTAKER IS IN TEMPORARY POSSESSION OF THE LAND COLOURED GREEN ON THESE LAND PLANS UNLESS STATED OTHERWISE IN THE BOOK OF REFERENCE.
3. THIS DRAWING IS TO BE READ IN CONJUNCTION WITH ALL OTHER PLANS AND DOCUMENTATION, IN PARTICULAR THE WORKS PLANS AND THE BOOK OF REFERENCE.

LEGEND

- ORDER LIMITS
- EXISTING PUBLIC RIGHT OF WAY
- PARISH BOUNDARY
- PLOT REFERENCE NUMBER
- LAND TO BE ACQUIRED PERMANENTLY
- LAND TO BE USED TEMPORARILY
- LAND TO BE USED TEMPORARILY AND RIGHTS TO BE ACQUIRED PERMANENTLY

Second Revision	By SC	27/02/2024	C02
Third Revision	By SC	24/07/2024	C03
Fourth Revision	By SC	17/09/2024	C04
Revision Details	By Check	Date	Suffix

Purpose of Issue: DCO APPLICATION

Client: Gloucestershire County Council

Development Consent Order Number: TR010063

Project Title: M5 JUNCTION 10 IMPROVEMENTS SCHEME

Development Consent Order Drawing Number: TR010063/APP/2.2

Drawing Title: LAND PLANS REGULATION 5(2)(i) SHEET 14 OF 16

Designed:	Drawn:	Checked:	Date:
--	SC	LE	17/09/2024

Internal Project Number:	Suitability:
J0041885-24-14j	DCO Submission

Scale @ A3:	Zone:
1:2,500	Whole Site

THIS DOCUMENT HAS BEEN PREPARED PURSUANT TO AND SUBJECT TO THE TERMS OF CARTER JONAS' APPOINTMENT BY ITS CLIENT. CARTER JONAS ACCEPTS NO LIABILITY FOR ANY USE OF THIS DOCUMENT OTHER THAN BY ITS ORIGINAL CLIENT OR FOLLOWING CARTER JONAS' EXPRESS AGREEMENT TO SUCH USE, AND ONLY FOR THE PURPOSES FOR WHICH IT WAS PREPARED AND PROVIDED

Rev:	C04
------	-----

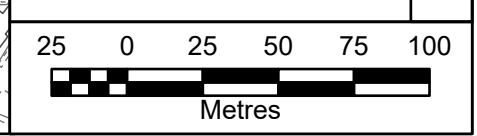



FOR CONTINUATION REFER TO SHEET 6

FOR CONTINUATION REFER TO SHEET 12

GLOUCESTERSHIRE COUNTY COUNCIL
PARISH OF UCKINGTON

NOTES:

1. ALL DIMENSIONS ARE IN METRES UNLESS STATED OTHERWISE.
2. ALL EASEMENTS, SERVITUDES AND PRIVATE RIGHTS ARE PROPOSED TO BE EXTINGUISHED ON LAND, COLOURED PINK ON THESE LAND PLANS UNLESS STATED OTHERWISE IN THE BOOK OF REFERENCE. ALL EASEMENTS, SERVITUDES AND PRIVATE RIGHTS ARE PROPOSED TO BE EXTINGUISHED, SO FAR AS THEIR CONTINUED EXERCISE WOULD BE INCONSISTENT WITH THE EXERCISE OF THE RIGHTS AND RESTRICTIONS PROPOSED TO BE ACQUIRED BY THE UNDERTAKER ON LAND COLOURED BLUE ON THESE LAND PLANS UNLESS STATED OTHERWISE IN THE BOOK OF REFERENCE. ALL EASEMENTS, SERVITUDES AND PRIVATE RIGHTS ARE PROPOSED TO BE SUSPENDED WHILE THE UNDERTAKER IS IN TEMPORARY POSSESSION OF THE LAND COLOURED GREEN ON THESE LAND PLANS UNLESS STATED OTHERWISE IN THE BOOK OF REFERENCE.
3. THIS DRAWING IS TO BE READ IN CONJUNCTION WITH ALL OTHER PLANS AND DOCUMENTATION, IN PARTICULAR THE WORKS PLANS AND THE BOOK OF REFERENCE.

LEGEND

- ORDER LIMITS
- EXISTING PUBLIC RIGHT OF WAY
- PARISH BOUNDARY
- PLOT REFERENCE NUMBER
- LAND TO BE ACQUIRED PERMANENTLY
- LAND TO BE USED TEMPORARILY AND RIGHTS TO BE ACQUIRED PERMANENTLY
- LAND TO BE USED TEMPORARILY

First Revision	By SC	29/02/2024	C01
Second Revision	By SC	24/07/2024	C02
Revision Details	By	Date	Suffix
	Check		

Purpose of Issue:
DCO APPLICATION

Client: Gloucestershire County Council

Development Consent Order Number:
TR010063

Project Title:
M5 JUNCTION 10 IMPROVEMENTS SCHEME

Development Consent Order Drawing Number:
TR010063/APP/2.2

Drawing Title:
**LAND PLANS
REGULATION 5(2)(i)
SHEET 15 OF 16**

Designed:	Drawn:	Checked:	Date:
--	SC	LE	24/07/2024

Internal Project Number: J0041885-24-15i	Suitability: DCO Submission
---	--------------------------------

Scale @ A3: 1:2,500	Zone: Whole Site
------------------------	---------------------

THIS DOCUMENT HAS BEEN PREPARED PURSUANT TO AND SUBJECT TO THE TERMS OF CARTER JONAS' APPOINTMENT BY ITS CLIENT. CARTER JONAS ACCEPTS NO LIABILITY FOR ANY USE OF THIS DOCUMENT OTHER THAN BY ITS ORIGINAL CLIENT OR FOLLOWING CARTER JONAS' EXPRESS AGREEMENT TO SUCH USE, AND ONLY FOR THE PURPOSES FOR WHICH IT WAS PREPARED AND PROVIDED

Rev:	C02
------	-----

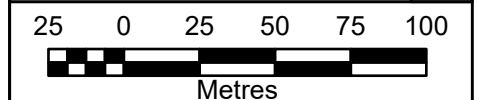

FOR CONTINUATION REFER TO SHEET 7

FOR CONTINUATION REFER TO SHEET 16



FOR CONTINUATION REFER TO SHEET 7

FOR CONTINUATION REFER TO SHEET 15

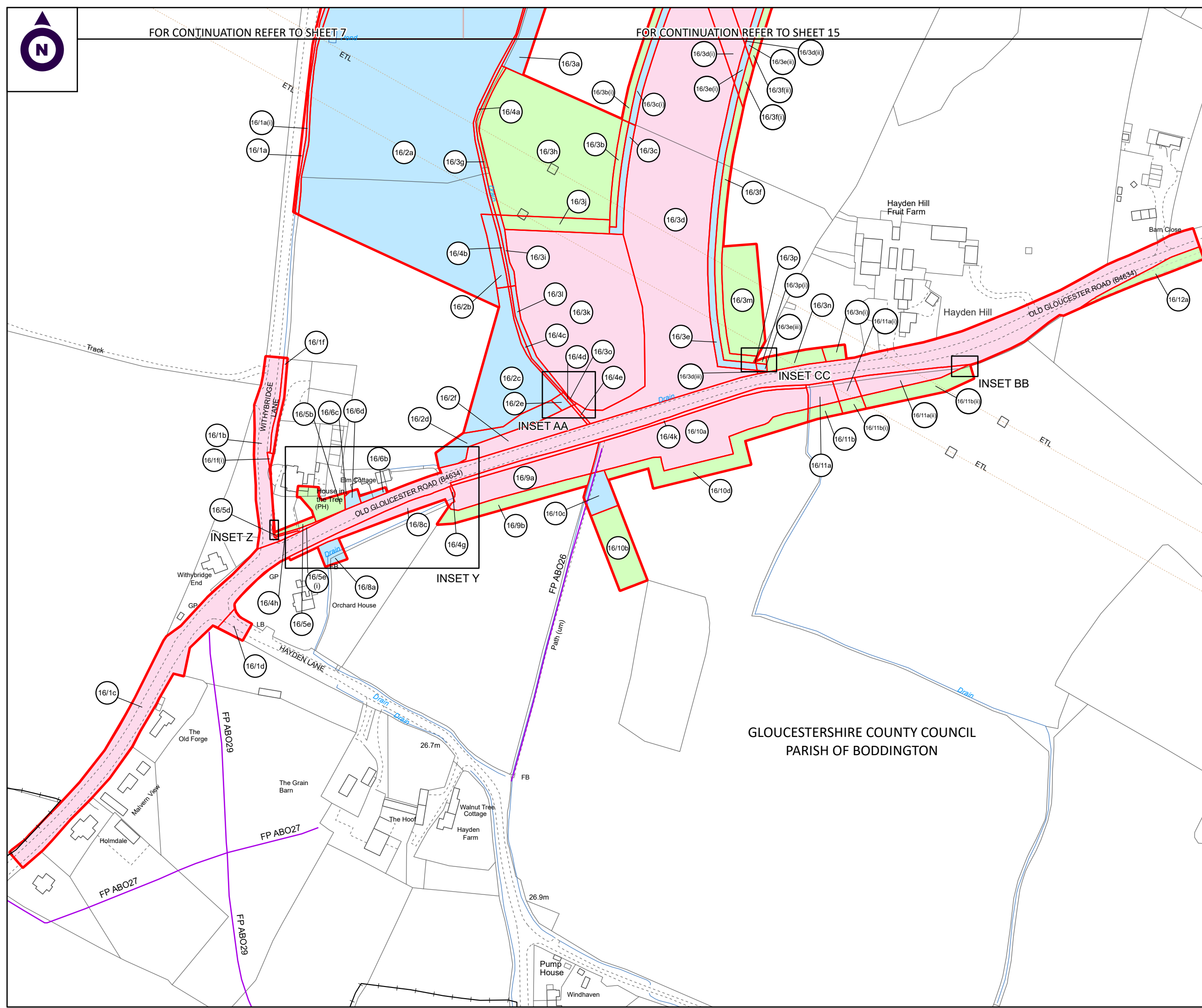

NOTES:

1. ALL DIMENSIONS ARE IN METRES UNLESS STATED OTHERWISE.
2. ALL EASEMENTS, SERVITUDES AND PRIVATE RIGHTS ARE PROPOSED TO BE EXTINGUISHED ON LAND, COLOURED PINK ON THESE LAND PLANS UNLESS STATED OTHERWISE IN THE BOOK OF REFERENCE. ALL EASEMENTS, SERVITUDES AND PRIVATE RIGHTS ARE PROPOSED TO BE EXTINGUISHED, SO FAR AS THEIR CONTINUED EXERCISE WOULD BE INCONSISTENT WITH THE EXERCISE OF THE RIGHTS AND RESTRICTIONS PROPOSED TO BE ACQUIRED BY THE UNDERTAKER ON LAND COLOURED BLUE ON THESE LAND PLANS UNLESS STATED OTHERWISE IN THE BOOK OF REFERENCE. ALL EASEMENTS, SERVITUDES AND PRIVATE RIGHTS ARE PROPOSED TO BE SUSPENDED WHILE THE UNDERTAKER IS IN TEMPORARY POSSESSION OF THE LAND COLOURED GREEN ON THESE LAND PLANS UNLESS STATED OTHERWISE IN THE BOOK OF REFERENCE.
3. THIS DRAWING IS TO BE READ IN CONJUNCTION WITH ALL OTHER PLANS AND DOCUMENTATION, IN PARTICULAR THE WORKS PLANS AND THE BOOK OF REFERENCE.

LEGEND

- ORDER LIMITS
- EXISTING PUBLIC RIGHT OF WAY
- PARISH BOUNDARY
- PLOT REFERENCE NUMBER
- LAND TO BE ACQUIRED PERMANENTLY
- LAND TO BE USED TEMPORARILY AND RIGHTS TO BE ACQUIRED PERMANENTLY
- LAND TO BE USED TEMPORARILY

Revision	By	Date	Suffix
Third Revision	EB	11/06/2024	C03
Fourth Revision	SC	24/07/2024	C04
Fifth Revision	SC	20/09/2024	C05
Revision Details	By	Date	Suffix
	Check		

Purpose of Issue: DCO APPLICATION

Client: Gloucestershire County Council

Development Consent Order Number: TR010063

Project Title:
M5 JUNCTION 10 IMPROVEMENTS SCHEME

Development Consent Order Drawing Number: TR010063/APP/2.2

Drawing Title:
LAND PLANS REGULATION 5(2)(i) SHEET 16 OF 16

Designed:	Drawn:	Checked:	Date:
--	SC	LE	20/09/2024

Internal Project Number:	Suitability:
J0041885-24-16l	DCO Submission

Scale @ A3:	Zone:
1:2,500	Whole Site

THIS DOCUMENT HAS BEEN PREPARED PURSUANT TO AND SUBJECT TO THE TERMS OF CARTER JONAS' APPOINTMENT BY ITS CLIENT. CARTER JONAS ACCEPTS NO LIABILITY FOR ANY USE OF THIS DOCUMENT OTHER THAN BY ITS ORIGINAL CLIENT OR FOLLOWING CARTER JONAS' EXPRESS AGREEMENT TO SUCH USE, AND ONLY FOR THE PURPOSES FOR WHICH IT WAS PREPARED AND PROVIDED

Rev:
C05

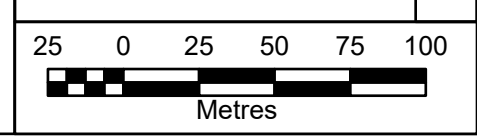



INSET Y @ 1:750

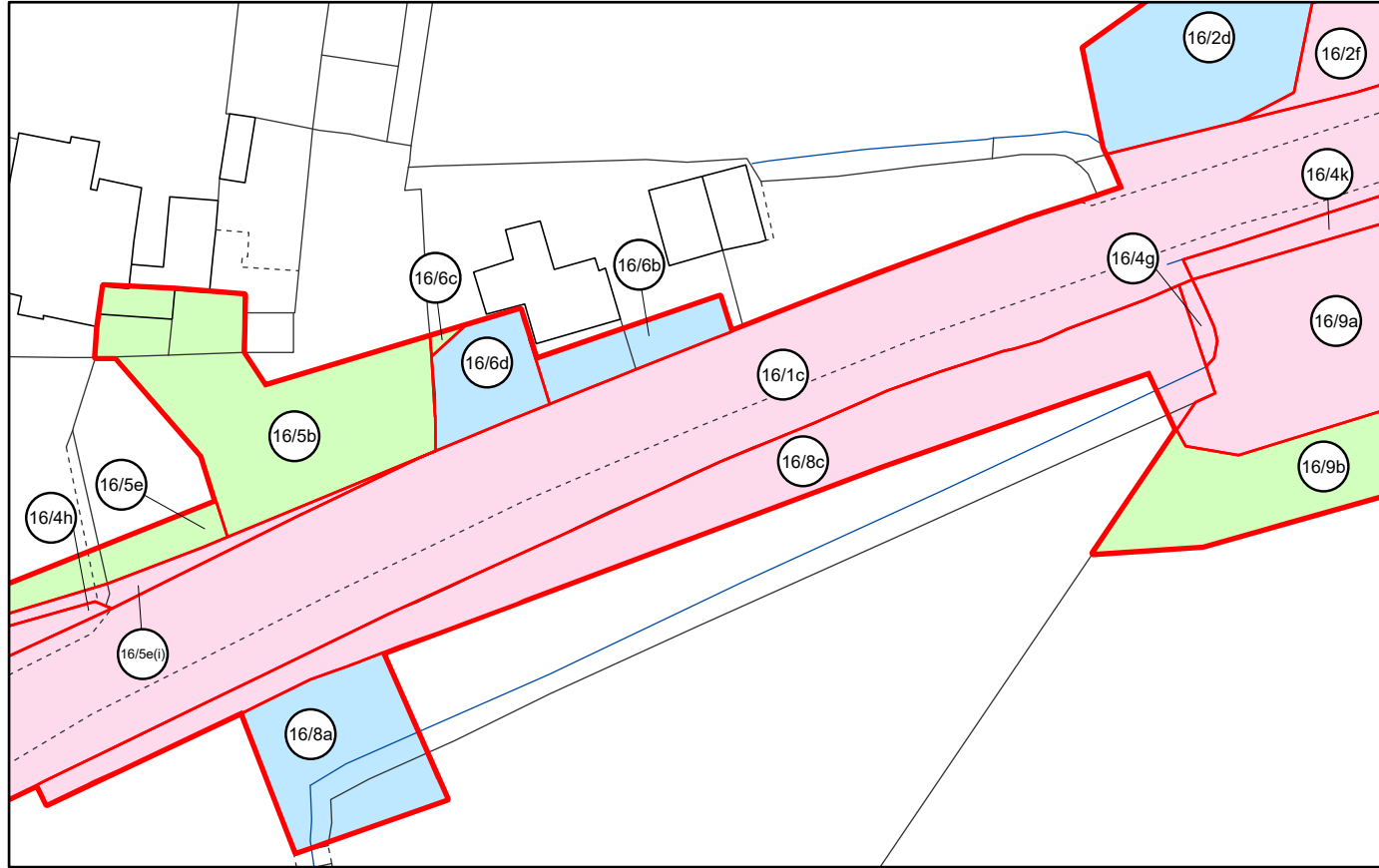

INSET Z @ 1:150

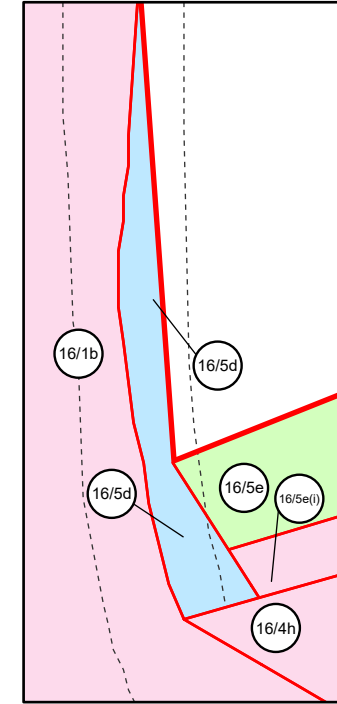

NOTES:

1. ALL DIMENSIONS ARE IN METRES UNLESS STATED OTHERWISE.
2. ALL EASEMENTS, SERVITUDES AND PRIVATE RIGHTS ARE PROPOSED TO BE EXTINGUISHED ON LAND, COLOURED PINK ON THESE LAND PLANS UNLESS STATED OTHERWISE IN THE BOOK OF REFERENCE. ALL EASEMENTS, SERVITUDES AND PRIVATE RIGHTS ARE PROPOSED TO BE EXTINGUISHED, SO FAR AS THEIR CONTINUED EXERCISE WOULD BE INCONSISTENT WITH THE EXERCISE OF THE RIGHTS AND RESTRICTIONS PROPOSED TO BE ACQUIRED BY THE UNDERTAKER ON LAND COLOURED BLUE ON THESE LAND PLANS UNLESS STATED OTHERWISE IN THE BOOK OF REFERENCE. ALL EASEMENTS, SERVITUDES AND PRIVATE RIGHTS ARE PROPOSED TO BE SUSPENDED WHILE THE UNDERTAKER IS IN TEMPORARY POSSESSION OF THE LAND COLOURED GREEN ON THESE LAND PLANS UNLESS STATED OTHERWISE IN THE BOOK OF REFERENCE.
3. THIS DRAWING IS TO BE READ IN CONJUNCTION WITH ALL OTHER PLANS AND DOCUMENTATION, IN PARTICULAR THE WORKS PLANS AND THE BOOK OF REFERENCE.

LEGEND

- ORDER LIMITS
- EXISTING PUBLIC RIGHT OF WAY
- PARISH BOUNDARY
- 1/1 PLOT REFERENCE NUMBER
- LAND TO BE ACQUIRED PERMANENTLY
- LAND TO BE USED TEMPORARILY
- LAND TO BE USED TEMPORARILY AND RIGHTS TO BE ACQUIRED PERMANENTLY

Revision Details	By	Date	Suffix
Second Revision	By EB	11/06/2024	C02
Third Revision	By SC	25/07/2024	C03
Fourth Revision	By SC	17/09/2024	C04

Purpose of Issue:
DCO APPLICATION

Client: Gloucestershire County Council

Development Consent Order Number:
TR010063

Project Title:
M5 JUNCTION 10 IMPROVEMENTS SCHEME

Development Consent Order Drawing Number:
TR010063/APP/2.2

Drawing Title:
LAND PLANS REGULATION 5(2)(i) SHEET 16A OF 16

Designed: --	Drawn: SC	Checked: LE	Date: 17/09/2024
--------------	-----------	-------------	------------------

Internal Project Number: J0041885-24-16-Ae	Suitability: DCO Submission
--	-----------------------------

Scale @ A3: 1:2,500	Zone: Whole Site
---------------------	------------------

THIS DOCUMENT HAS BEEN PREPARED PURSUANT TO AND SUBJECT TO THE TERMS OF CARTER JONAS' APPOINTMENT BY ITS CLIENT. CARTER JONAS ACCEPTS NO LIABILITY FOR ANY USE OF THIS DOCUMENT OTHER THAN BY ITS ORIGINAL CLIENT OR FOLLOWING CARTER JONAS' EXPRESS AGREEMENT TO SUCH USE, AND ONLY FOR THE PURPOSES FOR WHICH IT WAS PREPARED AND PROVIDED

Rev: C04

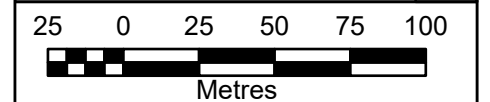

INSET AA @ 1:500

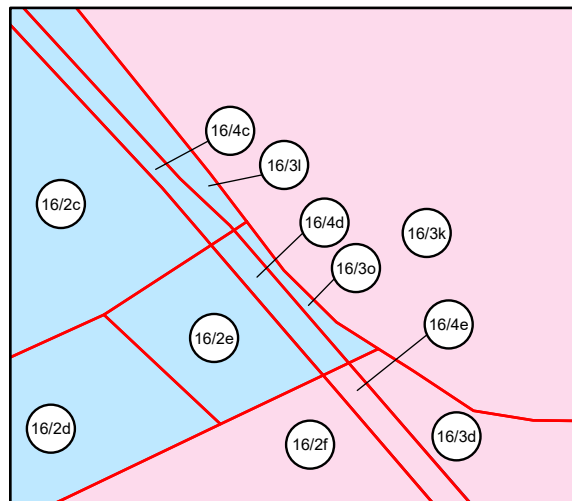

INSET BB @ 1:250

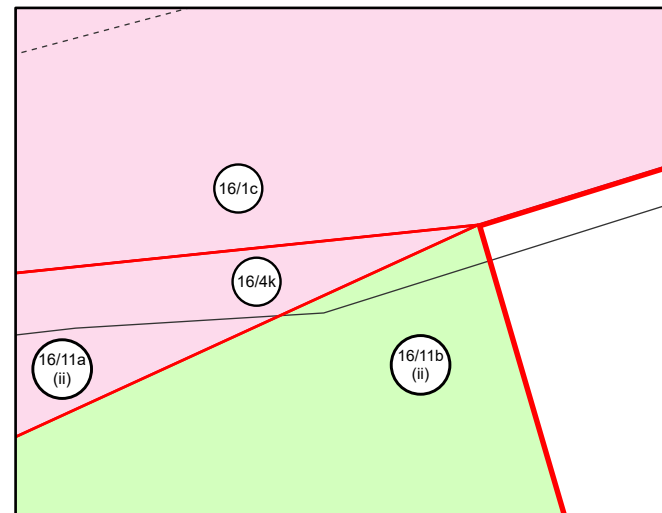

INSET CC @ 1:250

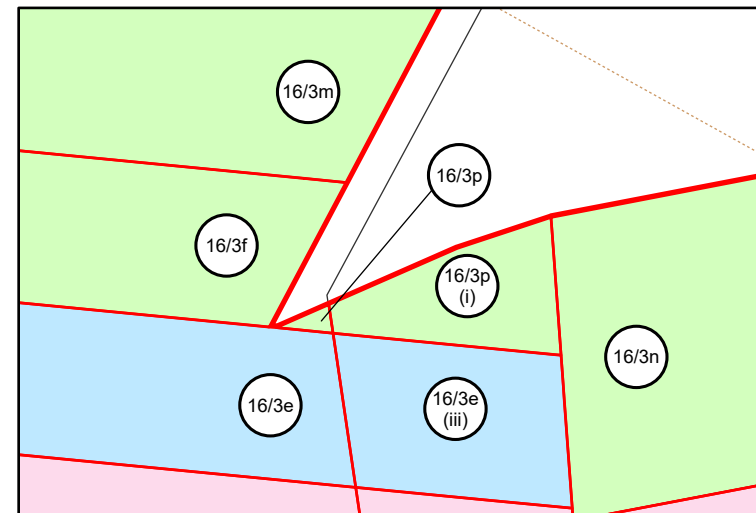

5th Floor, Block 5
Shire Hall
Bearland
Gloucester
GL1 2TH